

EAGLE MOUNTAIN – WOODFIBRE PIPELINE PROJECT ENGINEERING DESIGN DRAWING PACKAGE



KEY MAP

APDU 2.6 DRAWING LIST:

DRAWING NUMBER	DRAWING TITLE
TUNNEL ALIGNMENT	
62034-X-010-2006-R0	COVER SHEET AND DRAWING LIST - ADVANCED PARTIAL DESIGN UNIT 2.6
62034-C-100-2003-R0	TUNNEL ALIGNMENT KEY PLAN
62034-C-100-2020-R0	TUNNEL PLAN AND PROFILE - SHEET 1
62034-C-100-2021-R0	TUNNEL PLAN AND PROFILE - SHEET 2
62034-C-100-2022-R0	TUNNEL PLAN AND PROFILE - SHEET 3
62034-C-100-2023-R0	TUNNEL PLAN AND PROFILE - SHEET 4
62034-C-100-2024-R0	TUNNEL PLAN AND PROFILE - SHEET 5
62034-C-100-2025-R0	TUNNEL PLAN AND PROFILE - SHEET 6
62034-C-100-2026-R0	TUNNEL PLAN AND PROFILE - SHEET 7
62034-C-100-2027-R0	TUNNEL PLAN AND PROFILE - SHEET 8

ISSUED FOR CONSTRUCTION
2022-06-24

										EGP NORTH 610 TP PIPELINE
		ALDEA BY	RO No.	ISSUED FOR CONSTRUCTION REVISION	R. JIANG DRAWN	A. DELAMO DESIGNED	B. YANG CHECKED			2022-06-24 DATE (YYYY-MM-DD)

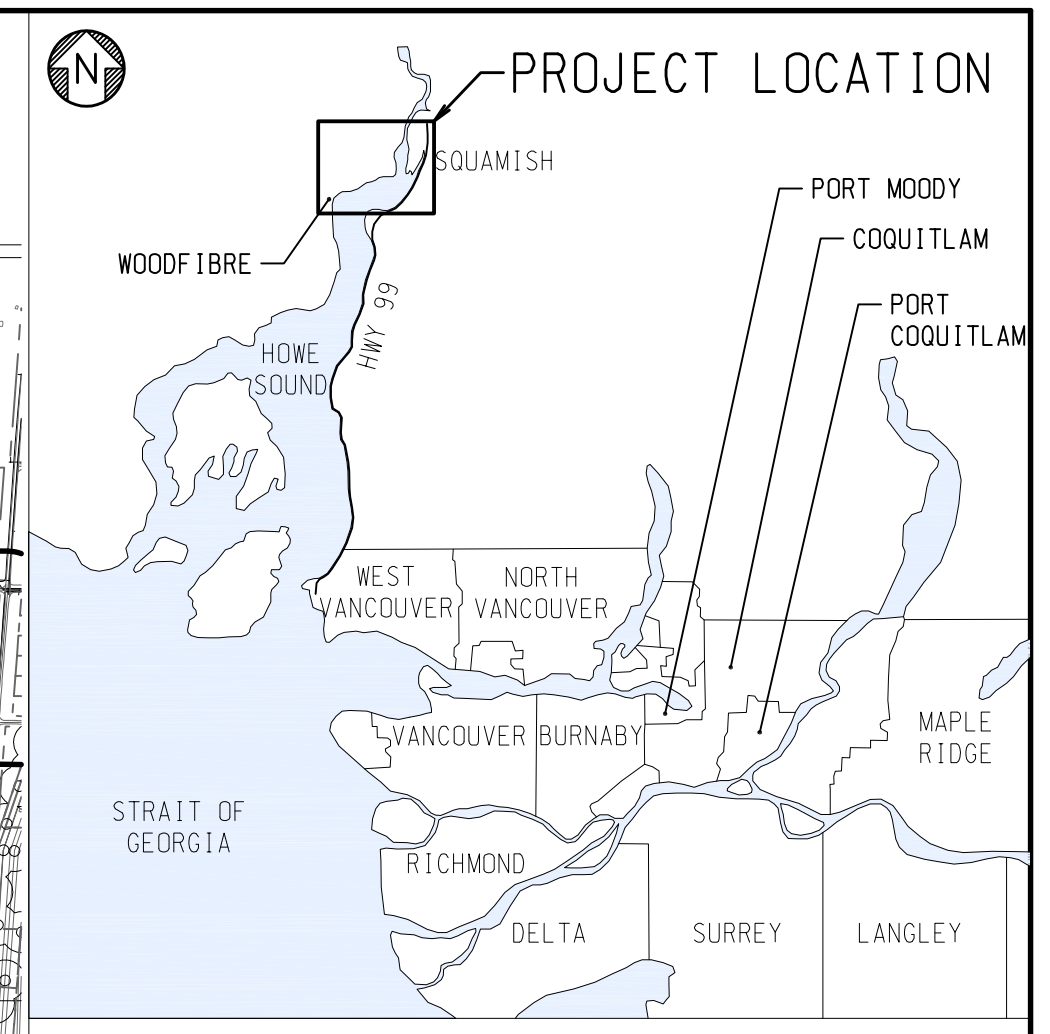
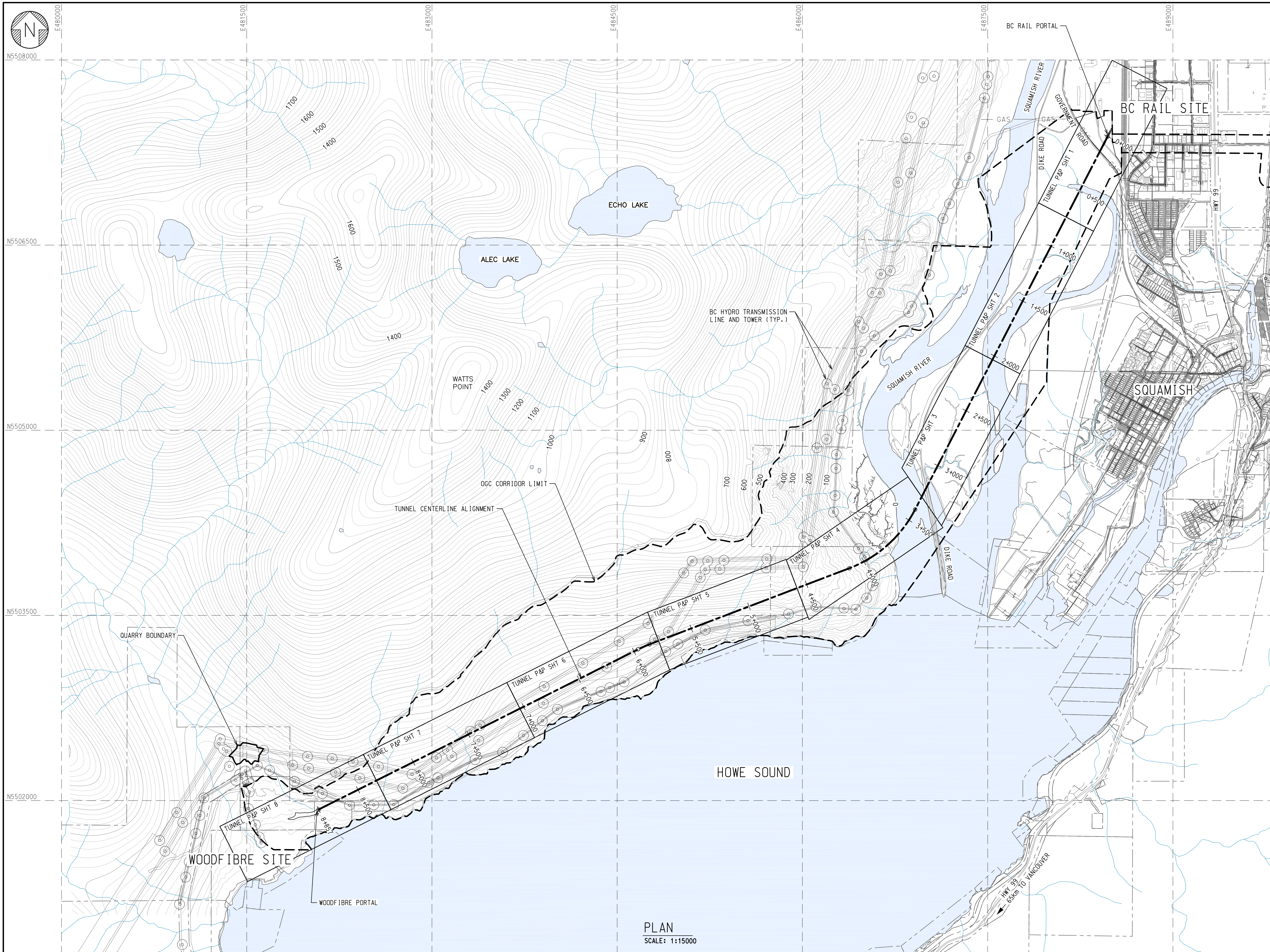

KEY PLAN
NTS

- MAPPING LEGEND:**
- 100 TOPOGRAPHIC CONTOURS
 - WATERCOURSE
 - GOVERNMENT ROAD
 - ROADWAY
 - PROPERTY BOUNDARY
 - BC RAILWAY
 - OGC CORRIDOR LIMIT
 - EXISTING FENCE LINE
 - EXISTING STORM WATER LINE
 - EXISTING OVERHEAD HYDRO LINE
 - EXISTING UNDERGROUND HYDRO LINE
 - EXISTING NATURAL GAS LINE
 - BUILDING/STRUCTURE OUTLINE
 - BC HYDRO TRANSMISSION LINES
 - BC HYDRO TRANSMISSION TOWER BUFFER ZONE

- MAPPING NOTES:**
1. DRAWINGS IN APDU 2.6 ARE IN METRES AND GEO-REFERENCED IN COORDINATE SYSTEM OF NAD83 UTM ZONE 10.
 2. ELEVATIONS ARE IN METRES AND REFER TO GEODETIC DATUM CGVD28.
 3. TUNNEL ALIGNMENT STATIONING IS IN METRES.
 4. REFER TO DU 3.1 FOR WOODFIBRE SITE FEATURES AND PROJECT BOUNDARIES.
 5. REFER TO DU 3.2 FOR BC RAIL SITE FEATURES AND PROJECT BOUNDARIES.
 6. REFER TO DU 3.3 FOR QUARRY SITE FEATURES AND PROJECT BOUNDARIES.

PLAN
SCALE: 1:15000

ISSUED FOR CONSTRUCTION
2022-06-24

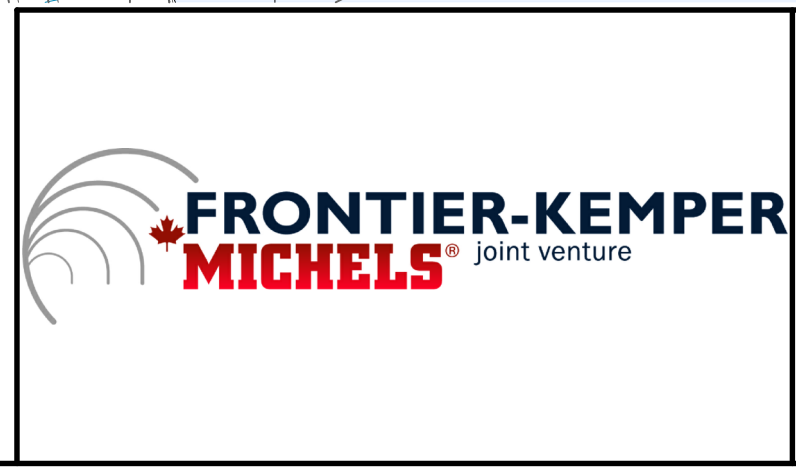
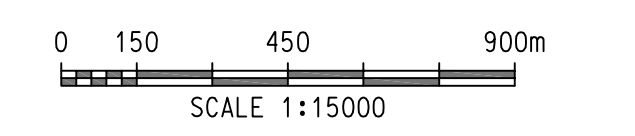

ALDEA	RO	ISSUED FOR CONSTRUCTION	R. JIANG	F. MERCURIELLO	B. YANG	2022-06-24
BY	No.	REVISION	DRAWN	DESIGNED	CHECKED	DATE (YYYY-MM-DD)
			PREVIOUS DR. NO. -		SCALE - AS SHOWN	

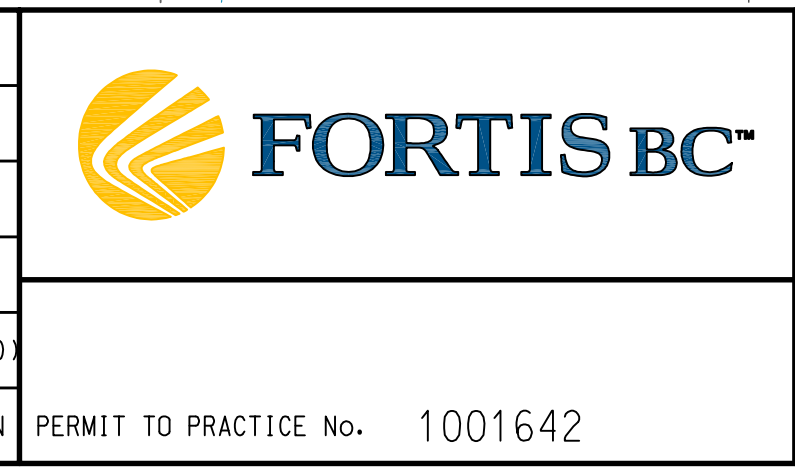

EGP NORTH 610 TP PIPELINE

TUNNEL ALIGNMENT KEY PLAN

DRAWING NUMBER 62034-C-100-2003-R0

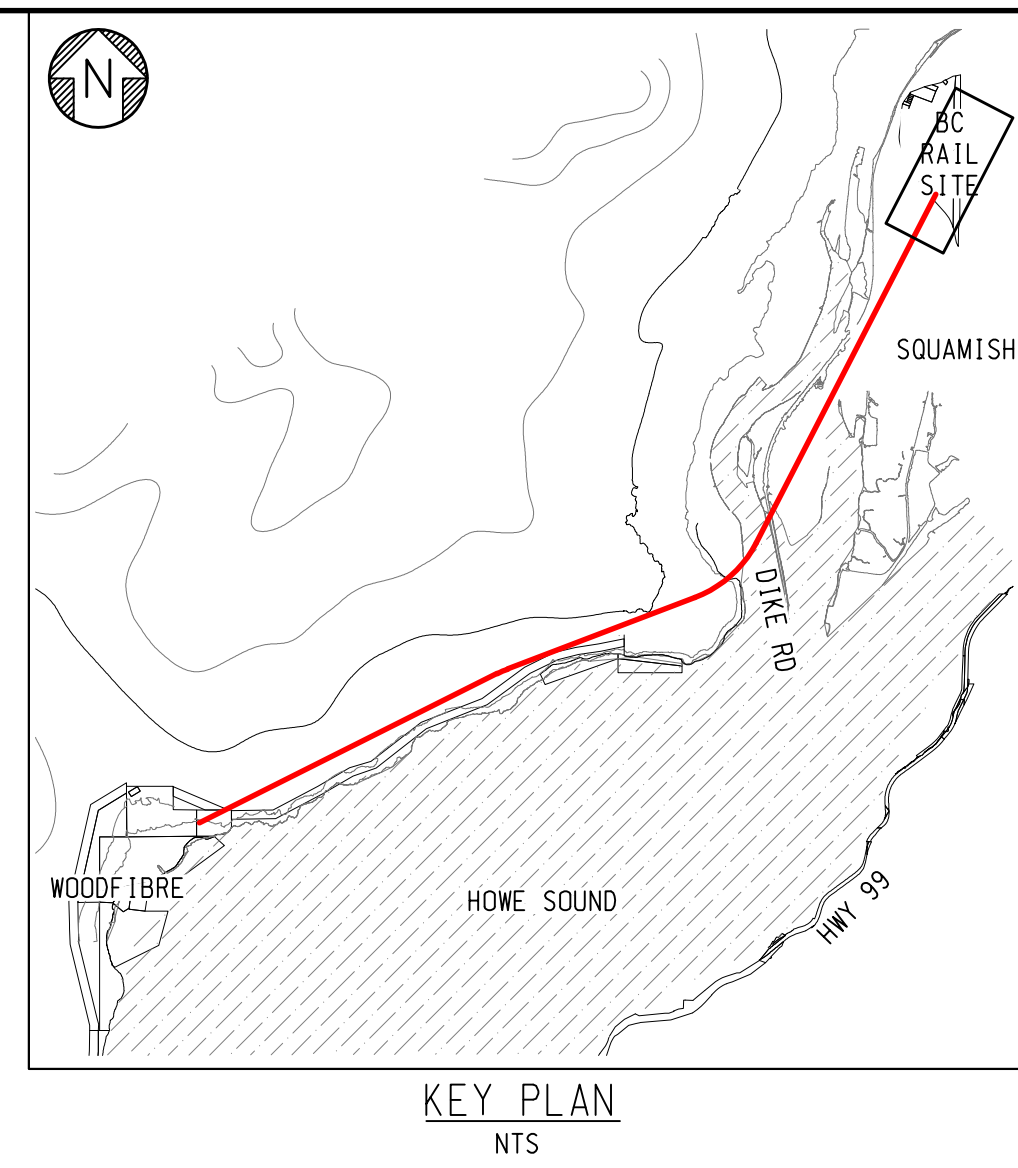
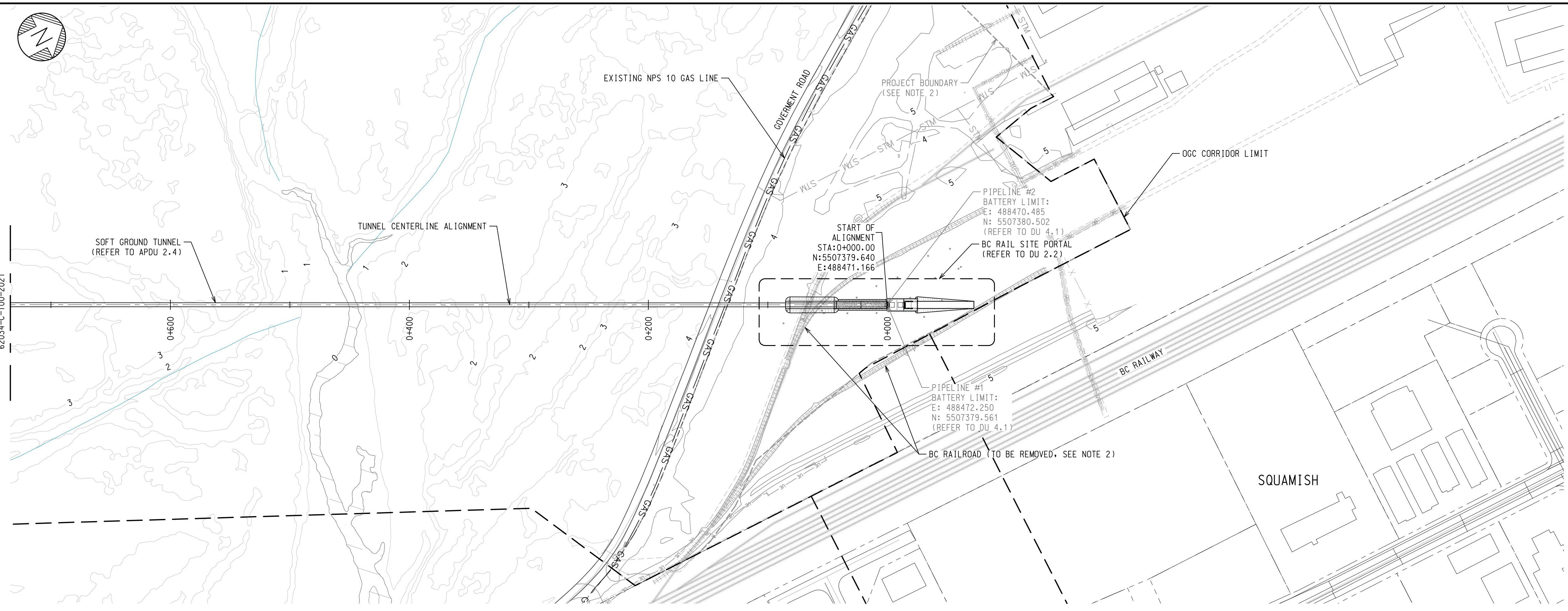

- NOTES:**
- REFER TO DWG 62034-C-100-2003 FOR MAPPING LEGEND AND NOTES.
 - REFER TO DU 3.2 FOR BC RAIL SITE PROJECT BOUNDARY AND EXTENT OF BC RAILROAD TRACK REMOVAL.

- ABBREVIATIONS/ACRONYMS:**
- APDU: ADVANCED PARTIAL DESIGN UNIT
 - BC: BEGINNING OF HORIZONTAL CURVE
 - BVCE: BEGINNING OF VERTICAL CURVE ELEVATION
 - BVCS: BEGINNING OF VERTICAL CURVE STATION
 - CL: CENTERLINE
 - DU: DESIGN UNIT
 - EC: END OF HORIZONTAL CURVE
 - EL / ELEV: ELEVATION
 - EVCE: END OF VERTICAL CURVE ELEVATION
 - EVCS: END OF VERTICAL CURVE STATION
 - GS: GROUND SURFACE
 - ID: INSIDE DIAMETER
 - K: K-VALUE REPRESENTS THE HORIZONTAL DISTANCE ALONG WHICH A 1% CHANGE IN GRADE OCCURS ON THE VERTICAL CURVE
 - LOW PT: LOW POINT ON VERTICAL CURVE
 - LVC: LENGTH OF VERTICAL CURVE
 - NPS: NOMINAL PIPE SIZE
 - OD: OUTSIDE DIAMETER
 - PCTL: PRECAST CONCRETE TUNNEL LINING
 - PVI: POINT OF VERTICAL INTERSECTION OF TWO ADJACENT TANGENTS
 - SL: SPRINGLINE
 - TBD: TO BE DETERMINED
 - TBM: TUNNEL BORING MACHINE
 - TYP: TYPICAL

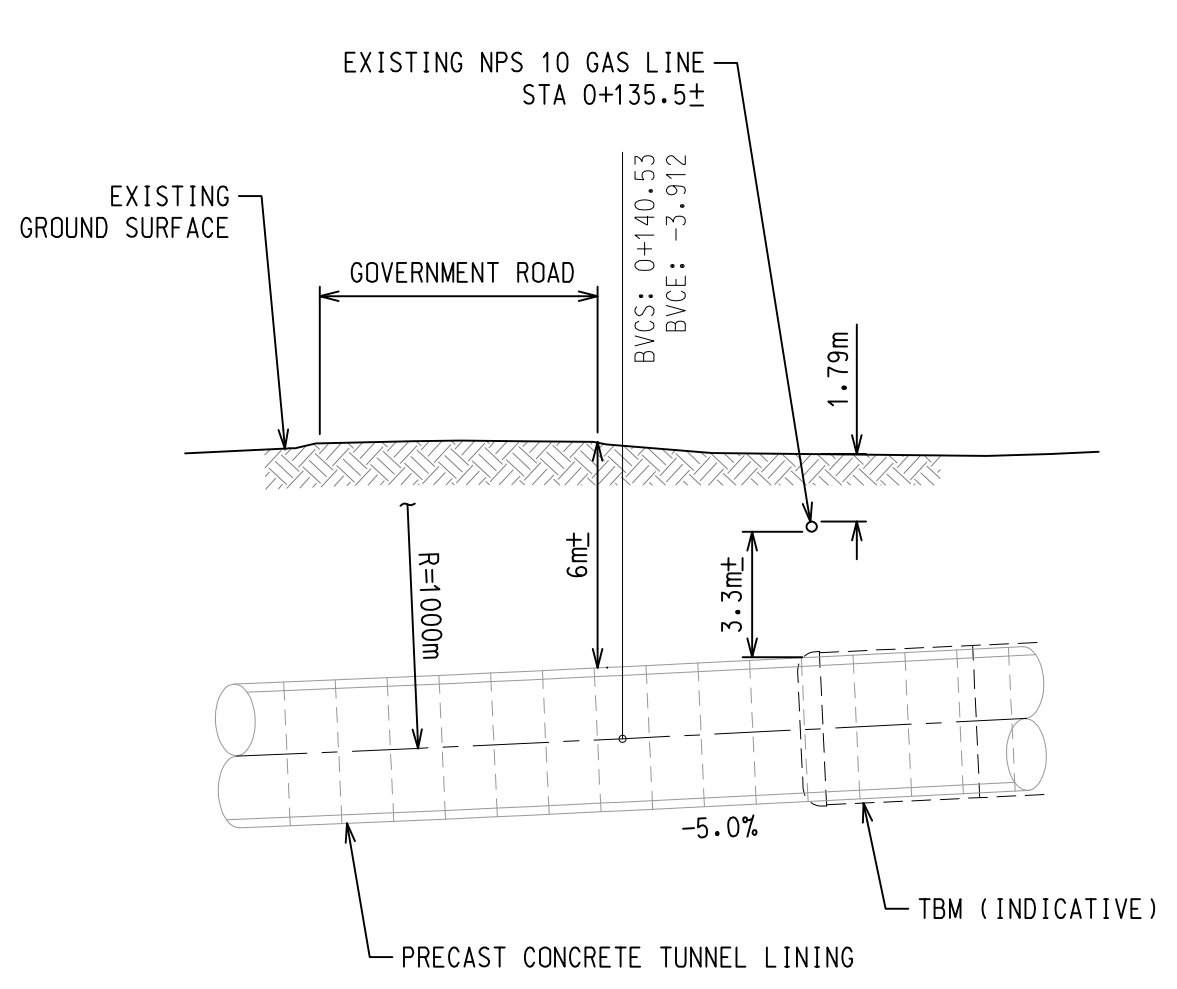
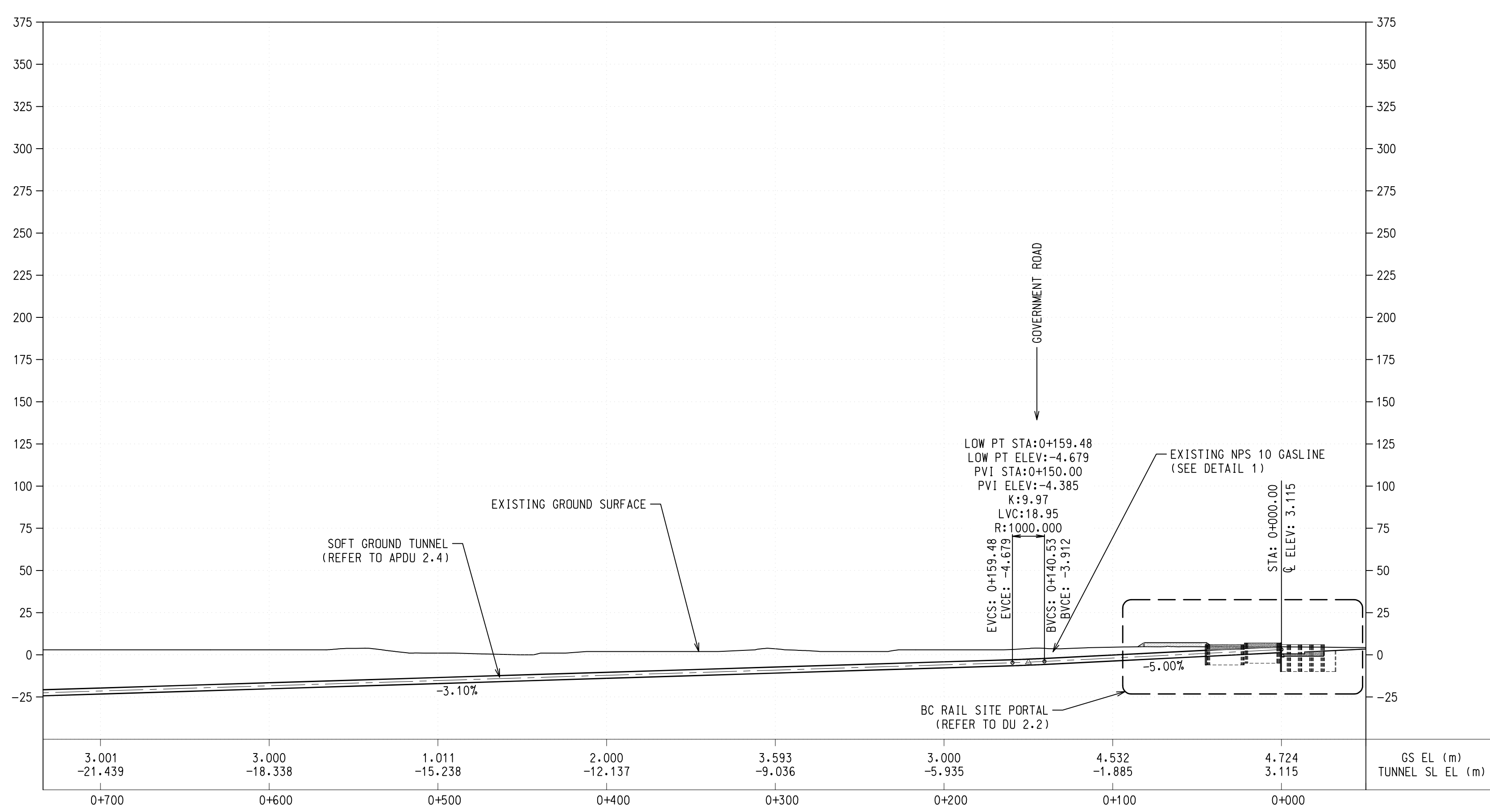

ISSUED FOR CONSTRUCTION
2022-06-24

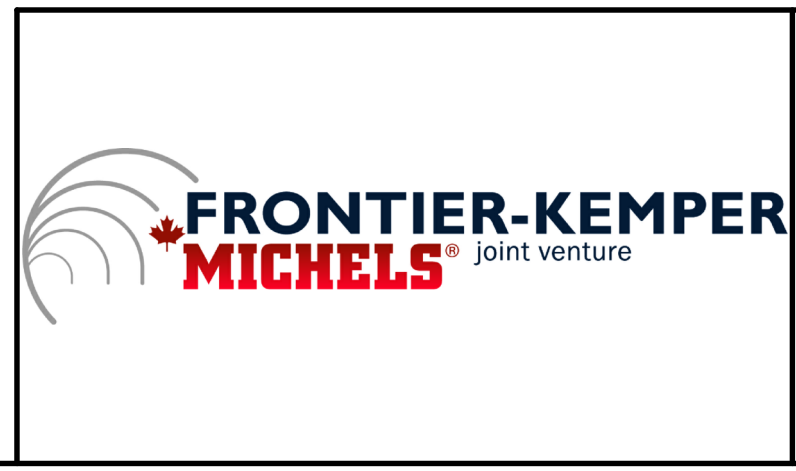
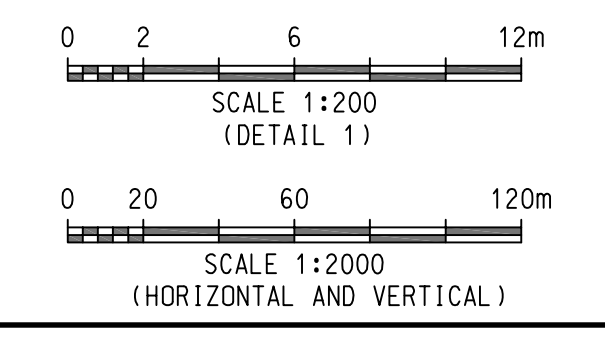

ALDEA	RO	ISSUED FOR CONSTRUCTION	R. JIANG	G. MONGE	B. YANG	2022-06-24
BY	No.	REVISION	DRAWN	DESIGNED	CHECKED	DATE (YYYY-MM-DD)
PREVIOUS DR. NO. -			SCALE - AS SHOWN			

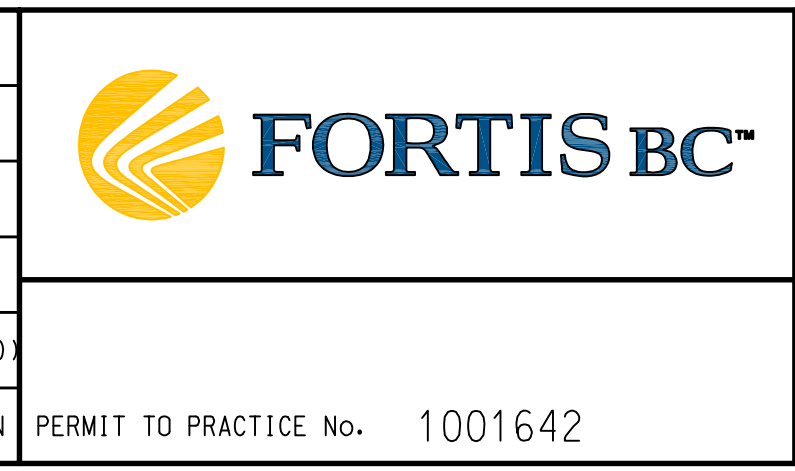

EGP NORTH 610 TP PIPELINE

TUNNEL PLAN AND PROFILE
SHEET 1
STA 0+000 TO STA 0+734

DRAWING NUMBER 62034-C-100-2020-R0

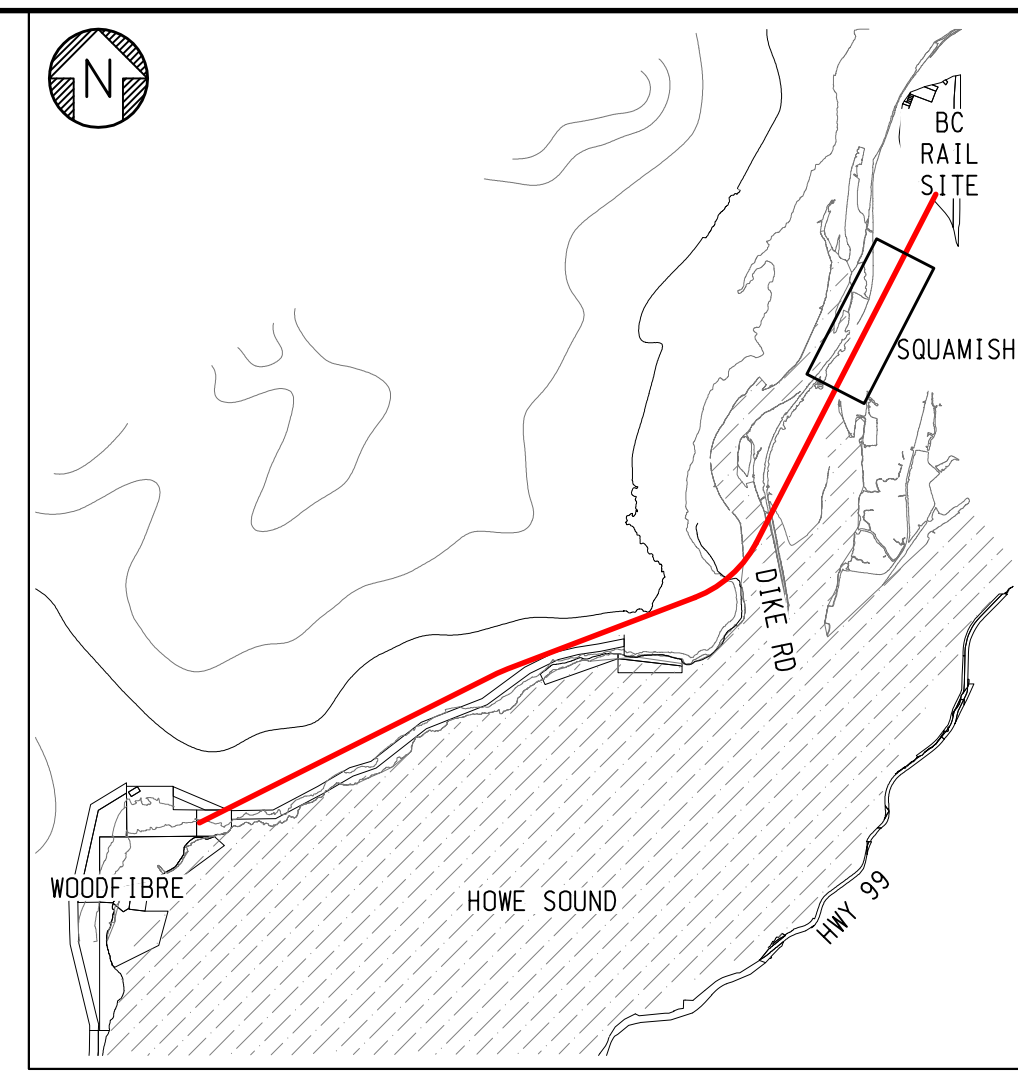
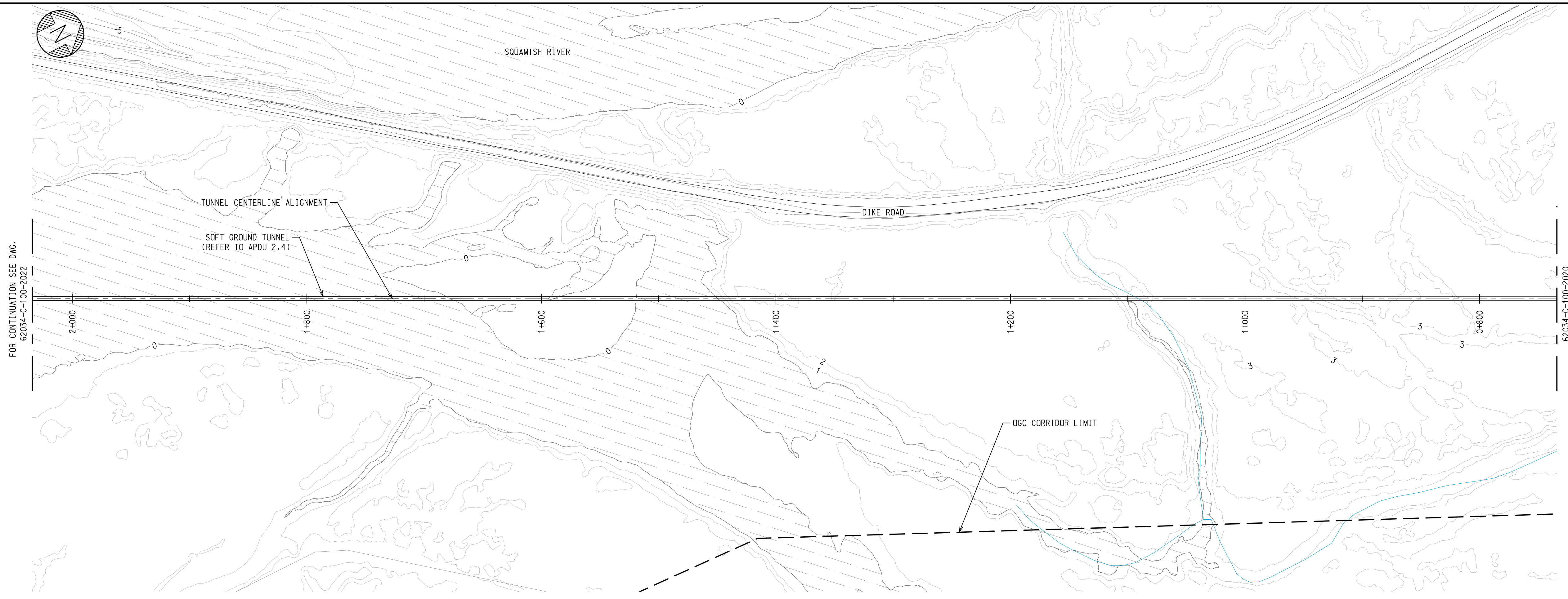

- NOTES:**
- REFER TO DWG 62034-C-100-2003 FOR MAPPING LEGEND AND NOTES.
 - REFER TO DWG 62034-C-100-2020 FOR ABBREVIATIONS AND ACRONYMS.

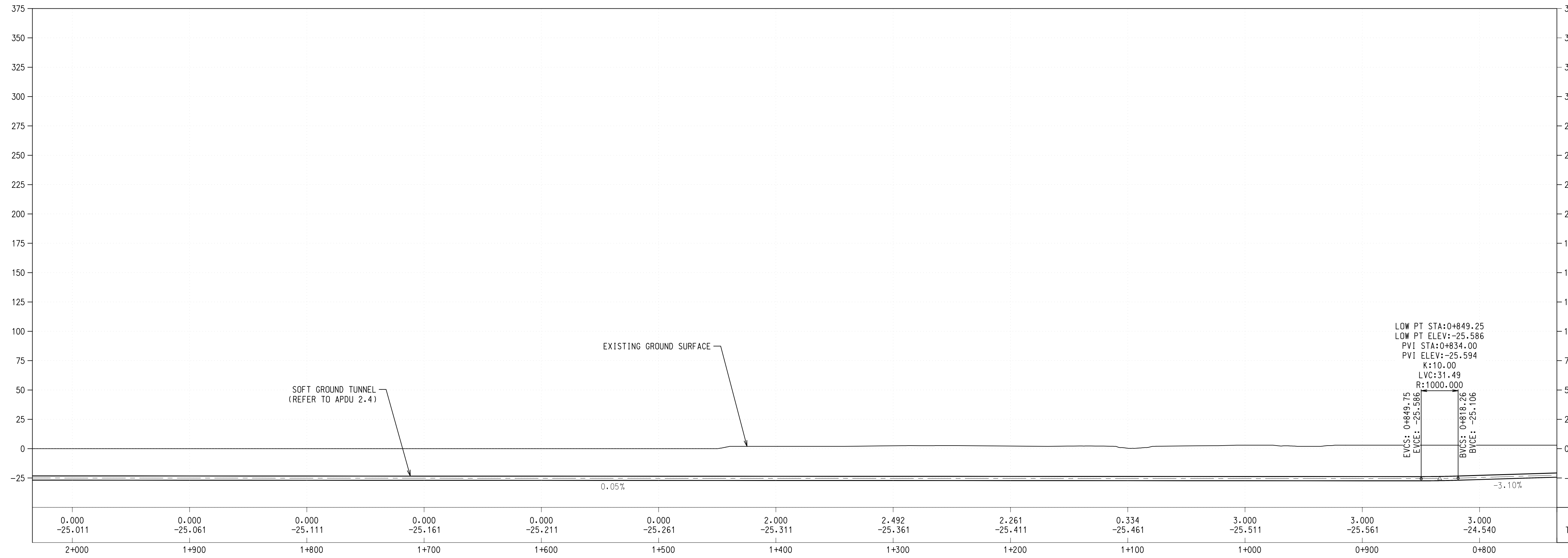

ISSUED FOR CONSTRUCTION
2022-06-24

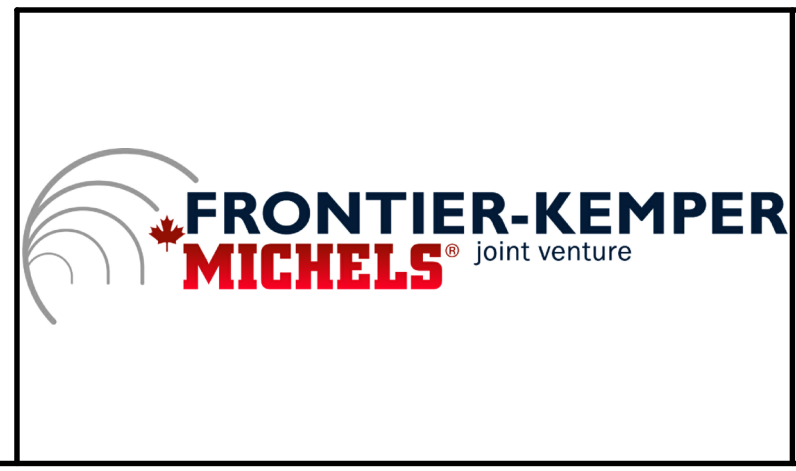
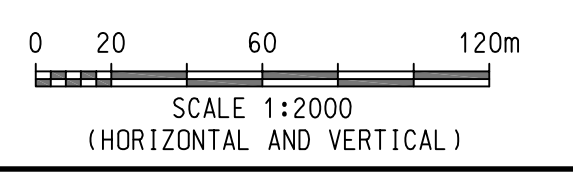

ALDEA	RO	ISSUED FOR CONSTRUCTION	R. JIANG	G. MONGE	B. YANG	2022-06-24
BY	No.	REVISION	DRAWN	DESIGNED	CHECKED	DATE (YYYY-MM-DD)
PREVIOUS DR. NO. -			SCALE - AS SHOWN			PERMIT TO PRACTICE No. 1001642

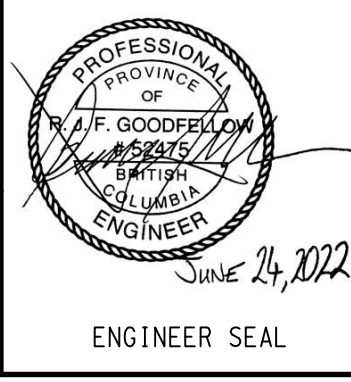

EGP NORTH 610 TP PIPELINE

TUNNEL PLAN AND PROFILE
SHEET 2
STA 0+734 TO STA 2+034

DRAWING NUMBER 62034-C-100-2021-R0

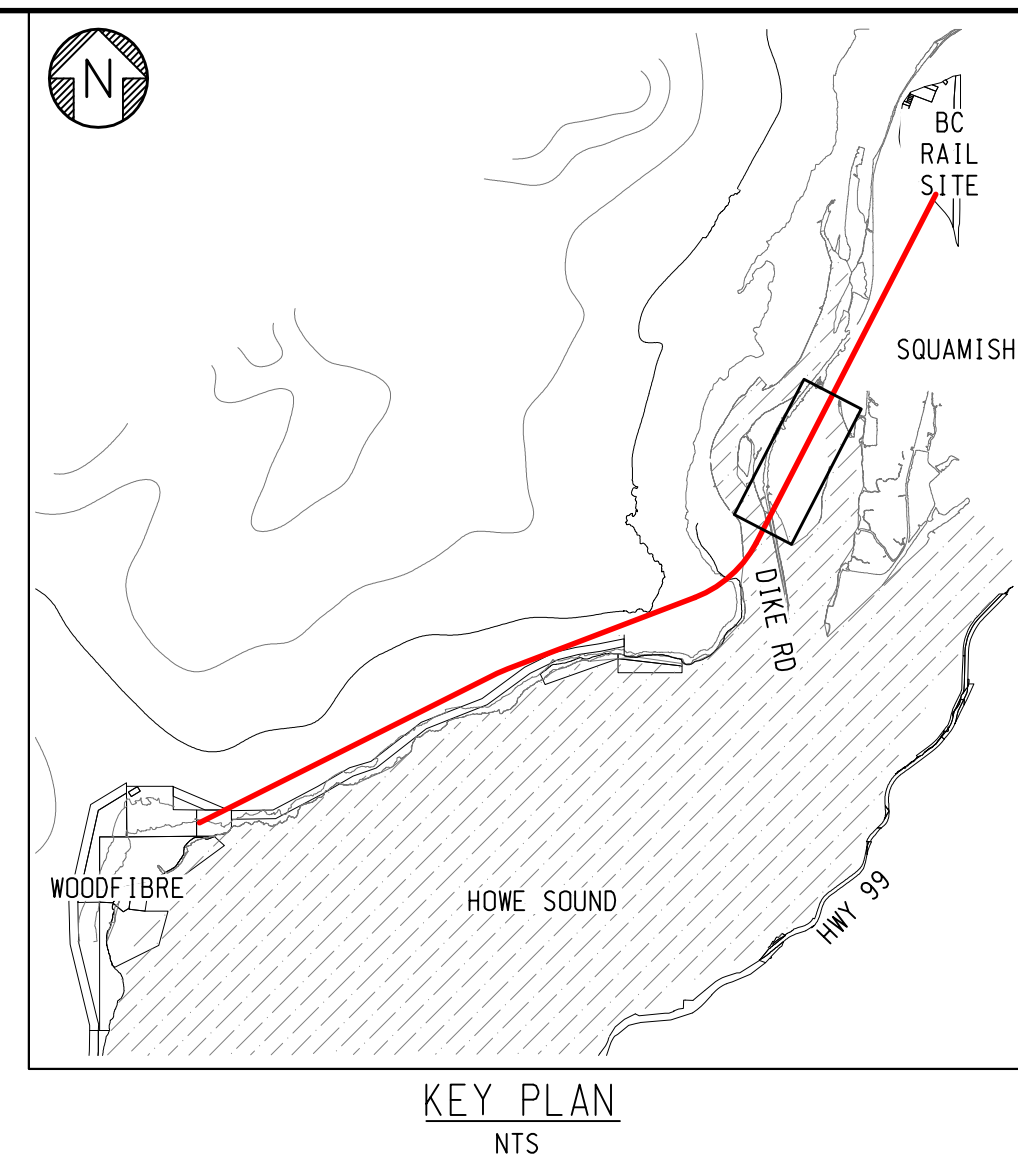
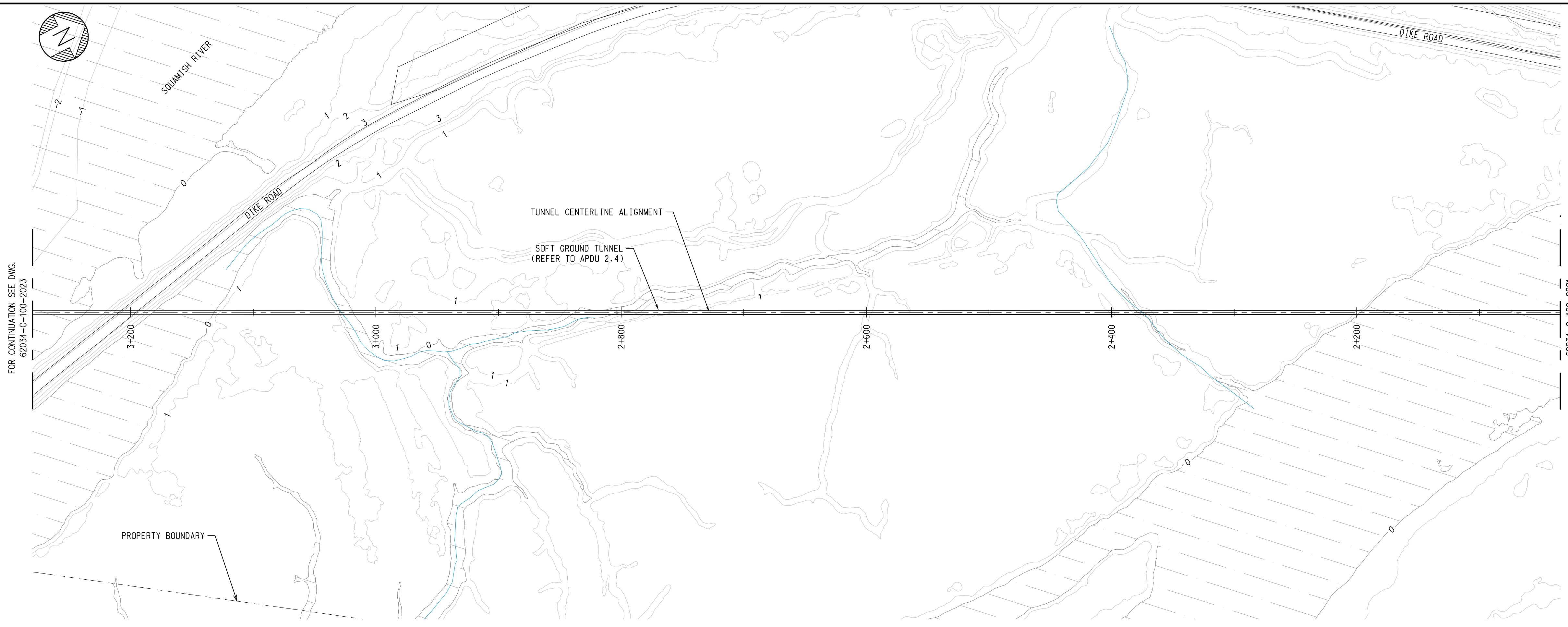

- NOTES:**
1. REFER TO DWG 62034-C-100-2003 FOR MAPPING LEGEND AND NOTES.
 2. REFER TO DWG 62034-C-100-2020 FOR ABBREVIATIONS AND ACRONYMS.

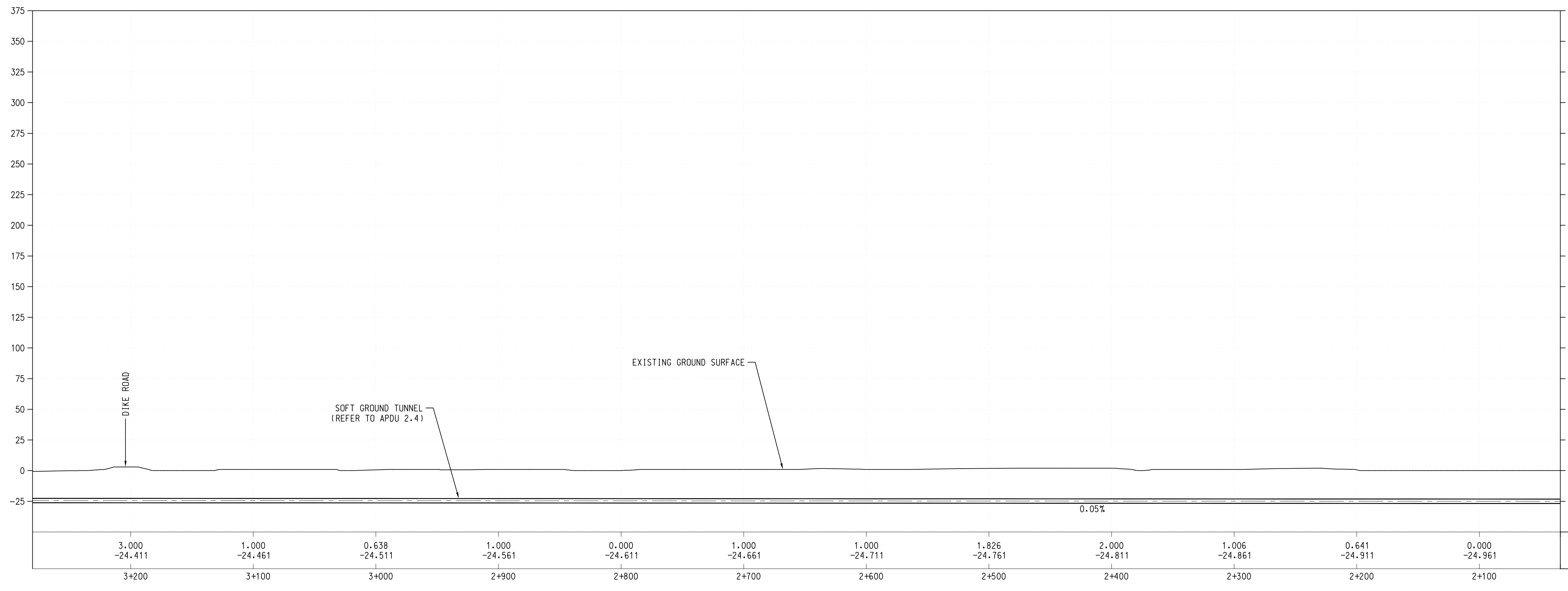

ISSUED FOR CONSTRUCTION
2022-06-24

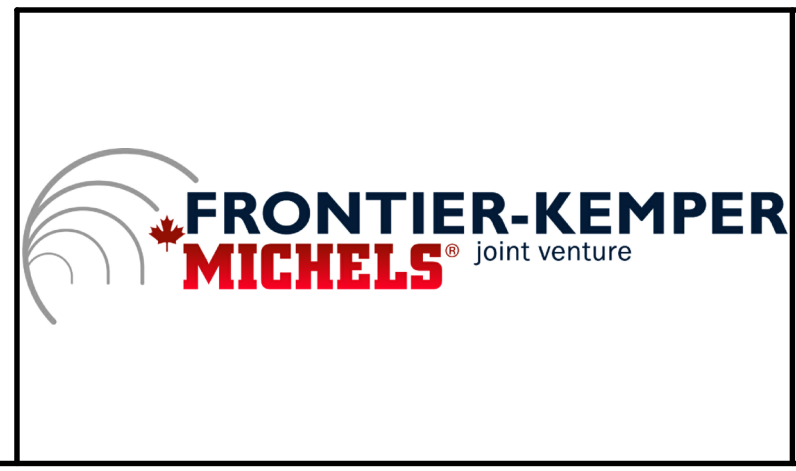
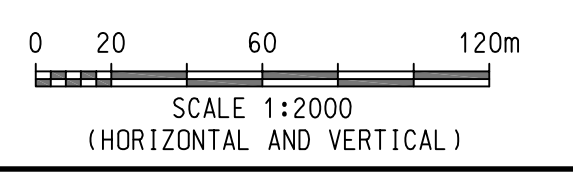

ALDEA	RO	ISSUED FOR CONSTRUCTION	R. JIANG	G. MONGE	B. YANG	2022-06-24
BY	No.	REVISION	DRAWN	DESIGNED	CHECKED	DATE (YYYY-MM-DD)
PREVIOUS DR. NO. -			SCALE - AS SHOWN			PERMIT TO PRACTICE No. 1001642

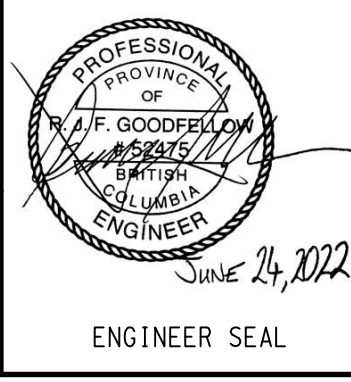

EGP NORTH 610 TP PIPELINE

TUNNEL PLAN AND PROFILE
SHEET 3
STA 2+034 TO STA 3+280

DRAWING NUMBER 62034-C-100-2022-R0

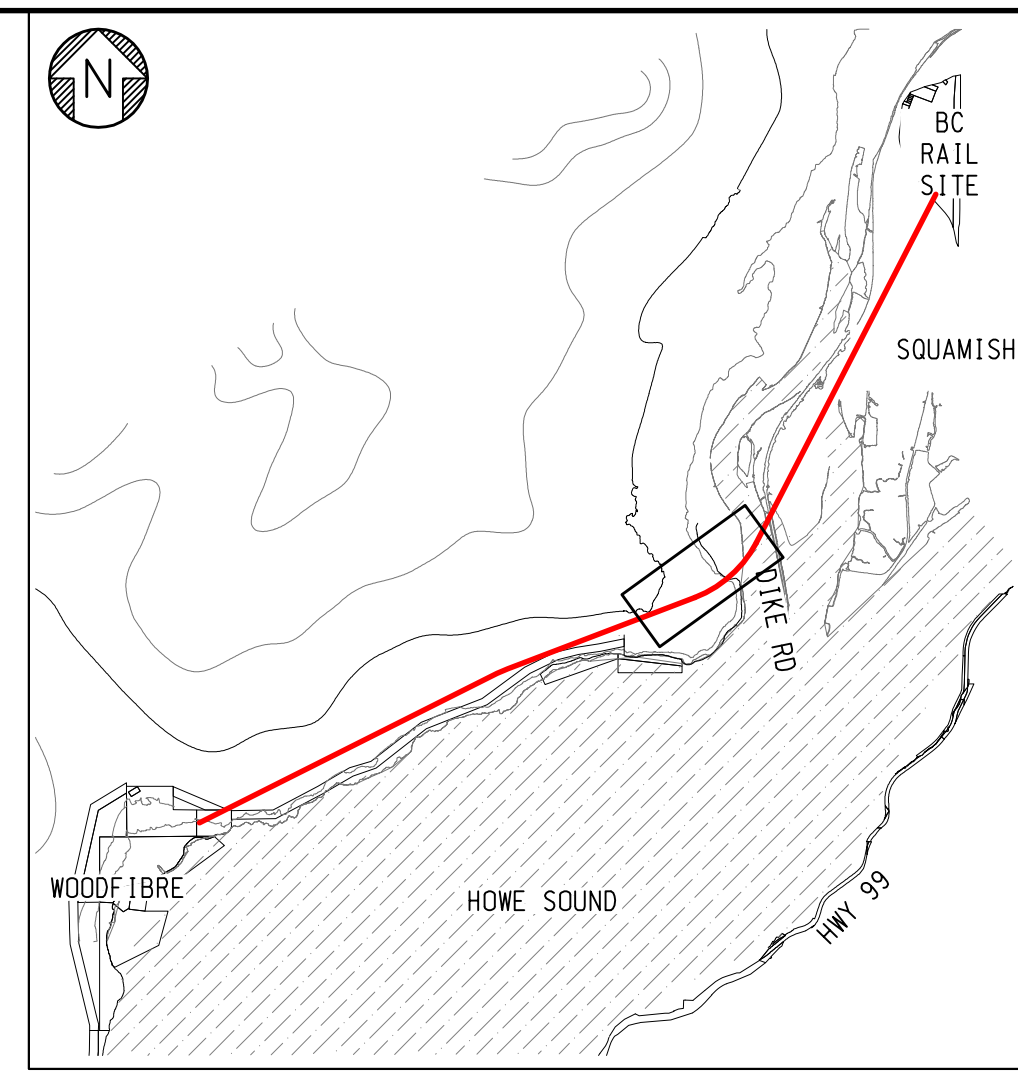
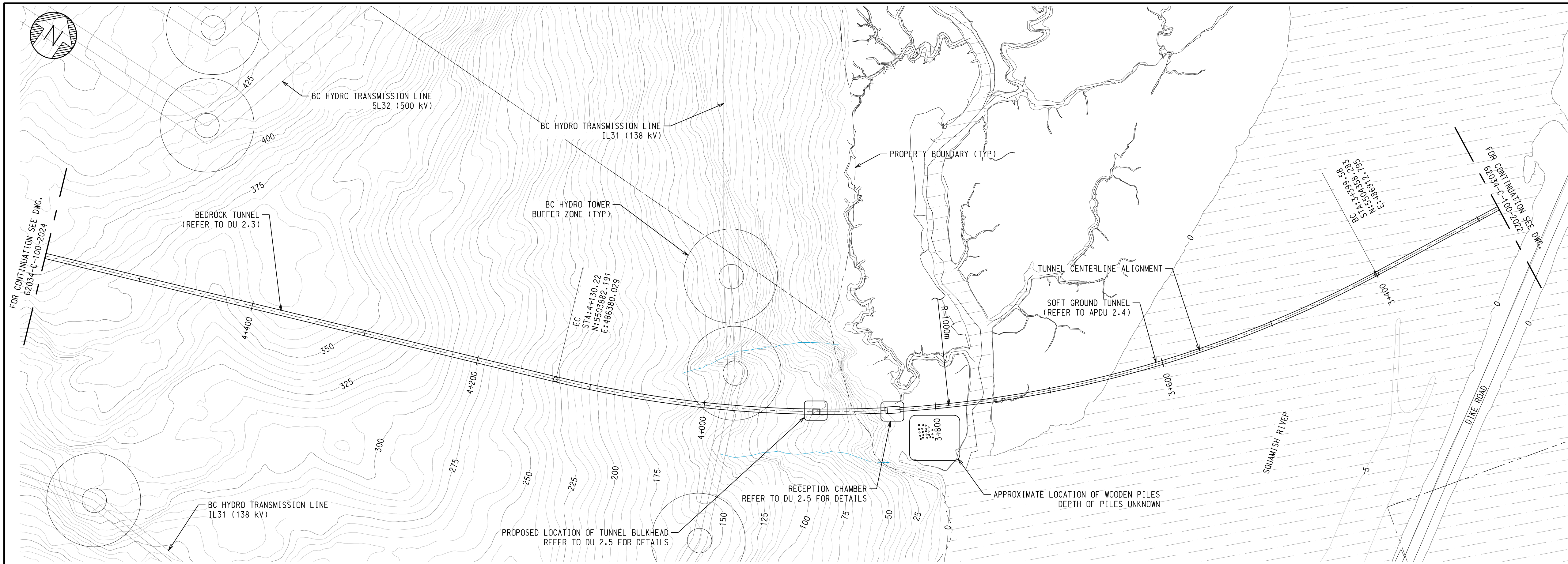

- NOTES:**
1. REFER TO DWG 62034-C-100-2003 FOR MAPPING LEGEND AND NOTES.
 2. REFER TO DWG 62034-C-100-2020 FOR ABBREVIATIONS AND ACRONYMS.
 3. DURING CONSTRUCTION, BOTH TBMS (BEDROCK AND SOFT GROUND) WILL CONFIRM THE INTERFACE REACH EXTENTS THROUGH PROBING AND STATIONS MAY VARY.

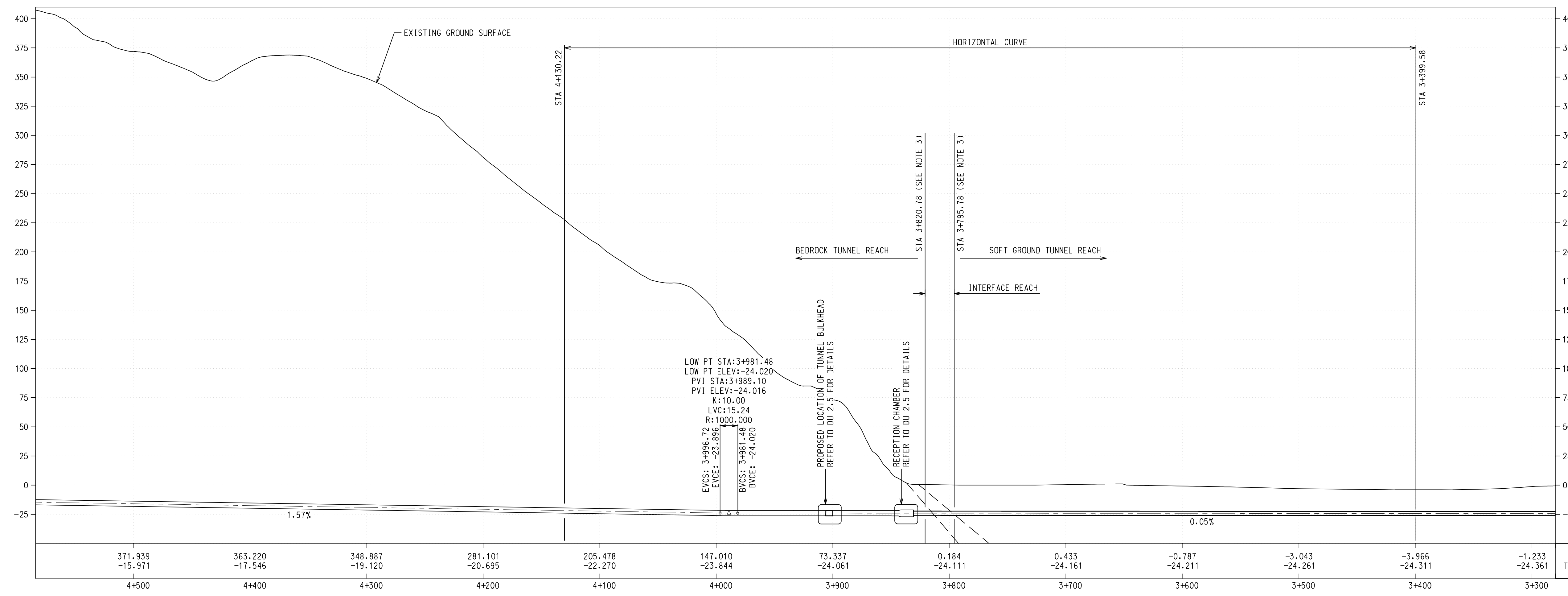

ISSUED FOR CONSTRUCTION
2022-06-24

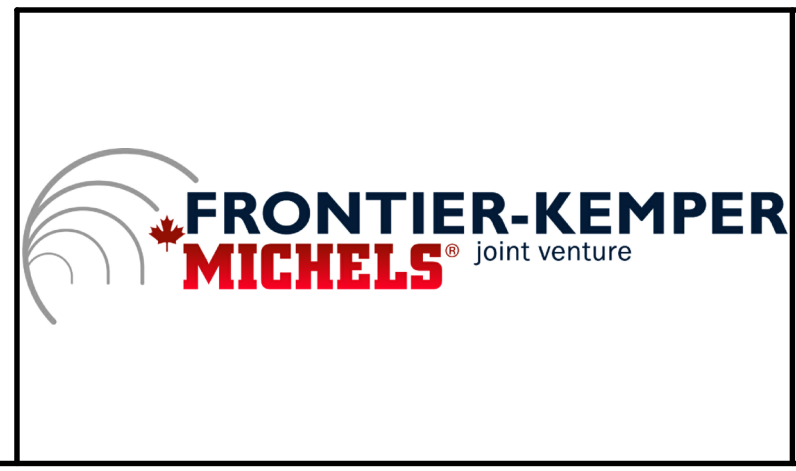
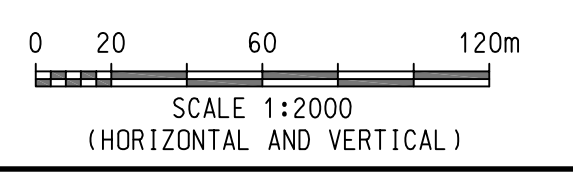

ALDEA	RO	ISSUED FOR CONSTRUCTION	R. JIANG	G. MONGE	B. YANG	2022-06-24
BY	No.	REVISION	DRAWN	DESIGNED	CHECKED	DATE (YYYY-MM-DD)
PREVIOUS DR. NO. -						SCALE - AS SHOWN

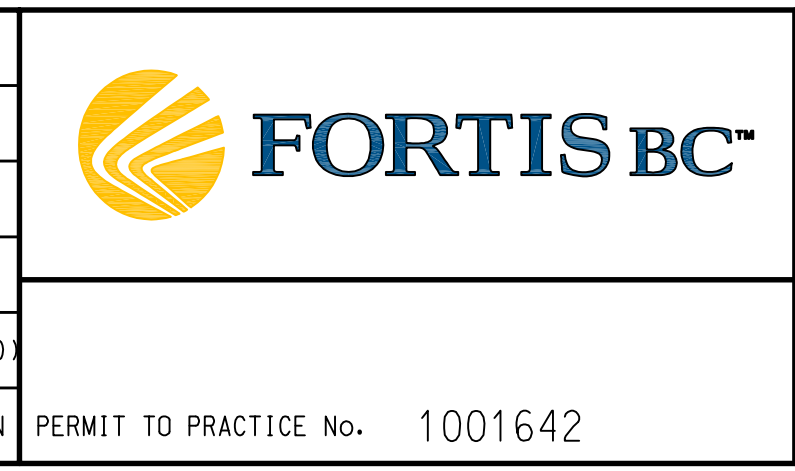

EGP NORTH 610 TP PIPELINE

TUNNEL PLAN AND PROFILE
SHEET 4
STA 3+280 TO STA 4+584

DRAWING NUMBER 62034-C-100-2023-R0

PERMIT TO PRACTICE No. 1001642

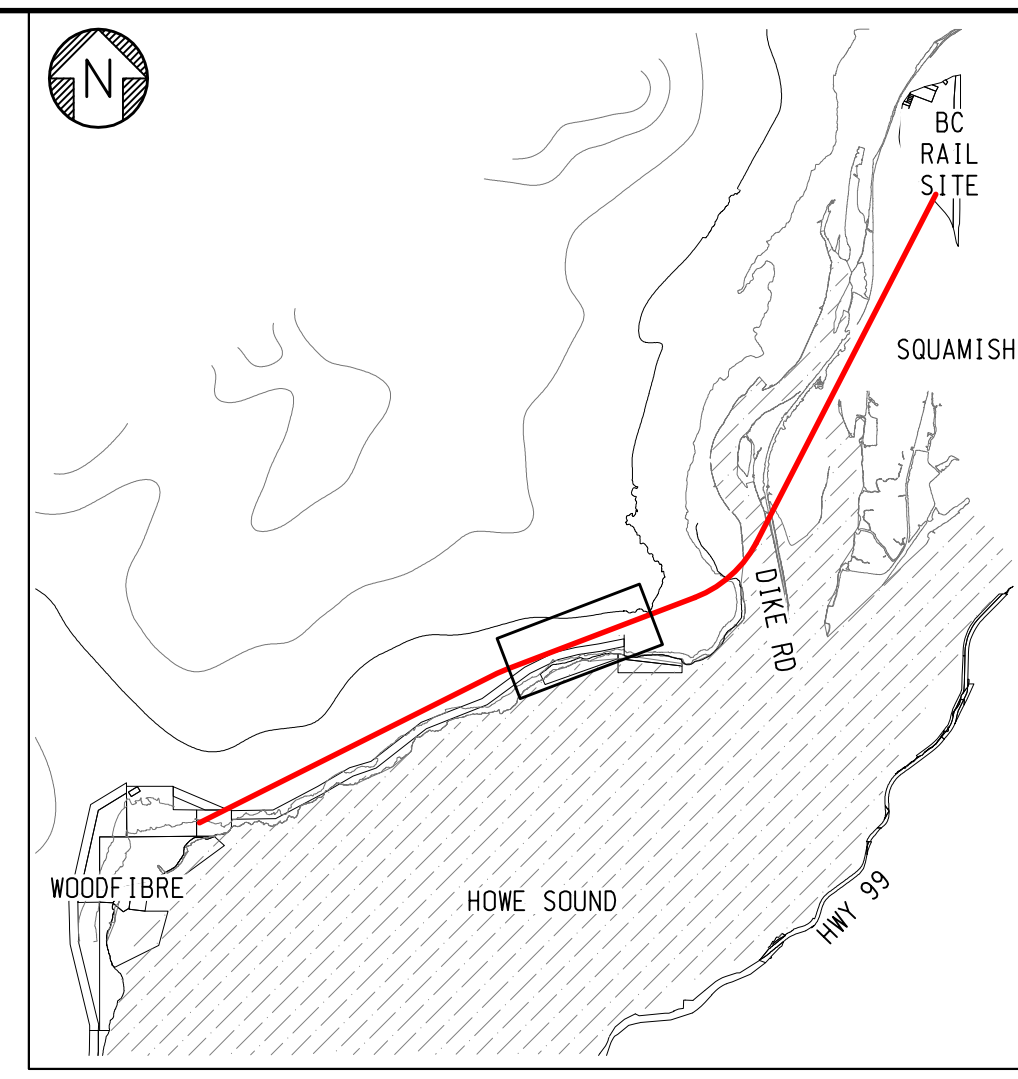
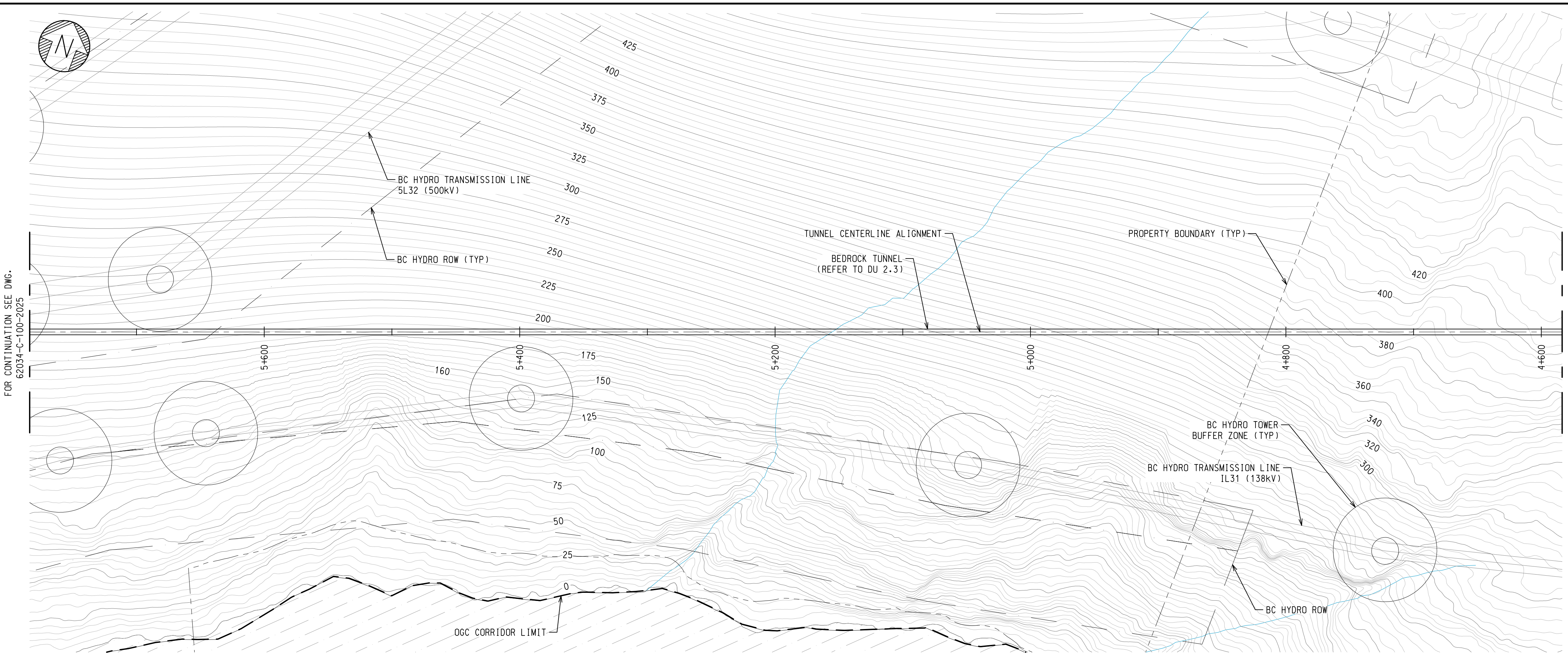

- NOTES:**
1. REFER TO DWG 62034-C-100-2003 FOR MAPPING LEGEND AND NOTES.
 2. REFER TO DWG 62034-C-100-2020 FOR ABBREVIATIONS AND ACRONYMS.

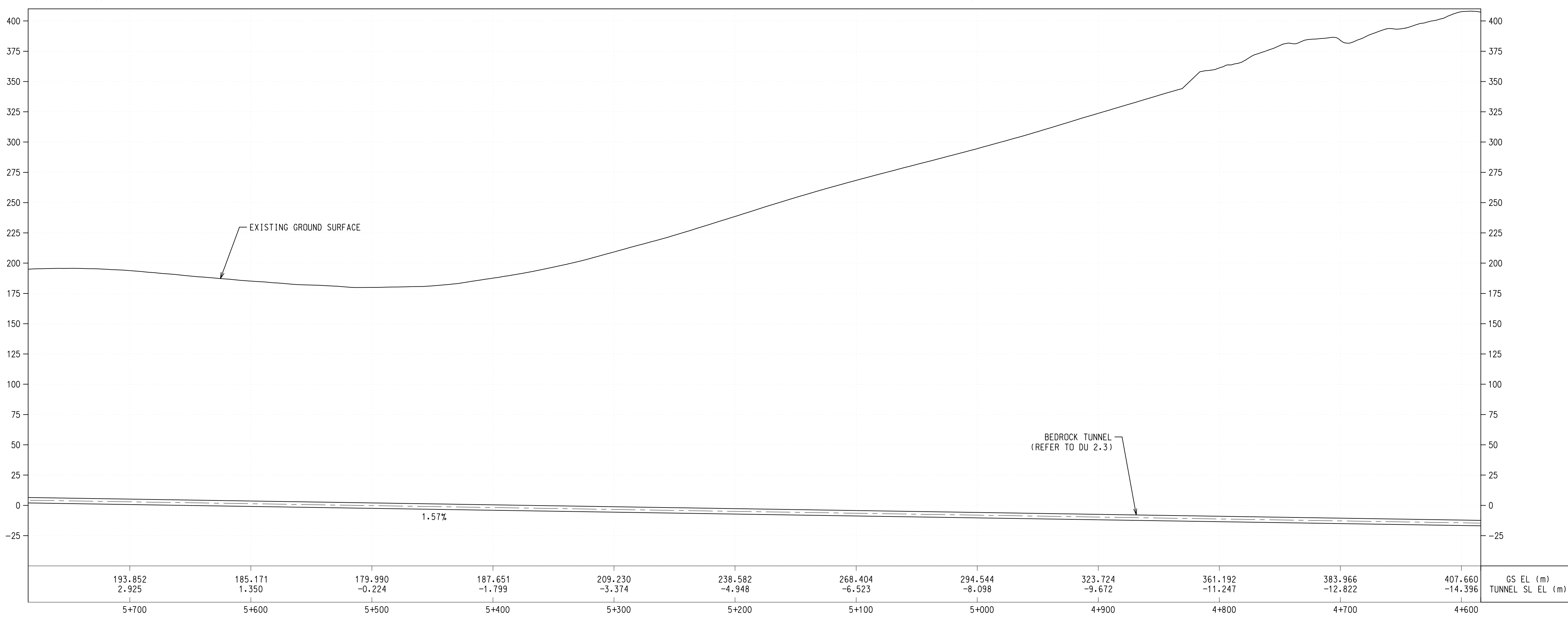

ISSUED FOR CONSTRUCTION
2022-06-24

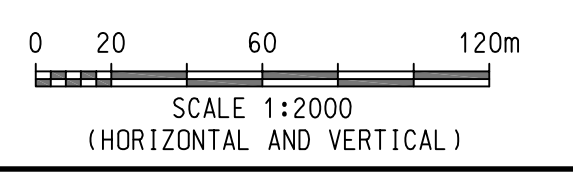

ALDEA	RO	ISSUED FOR CONSTRUCTION	R. JIANG	G. MONGE	B. YANG	2022-06-24
BY	No.	REVISION	DRAWN	DESIGNED	CHECKED	DATE (YYYY-MM-DD)
PREVIOUS DR. NO. -			SCALE - AS SHOWN			PERMIT TO PRACTICE No. 1001642



EGP NORTH 610 TP PIPELINE

TUNNEL PLAN AND PROFILE
SHEET 5
STA 4+584 TO STA 5+784

DRAWING NUMBER 62034-C-100-2024-R0

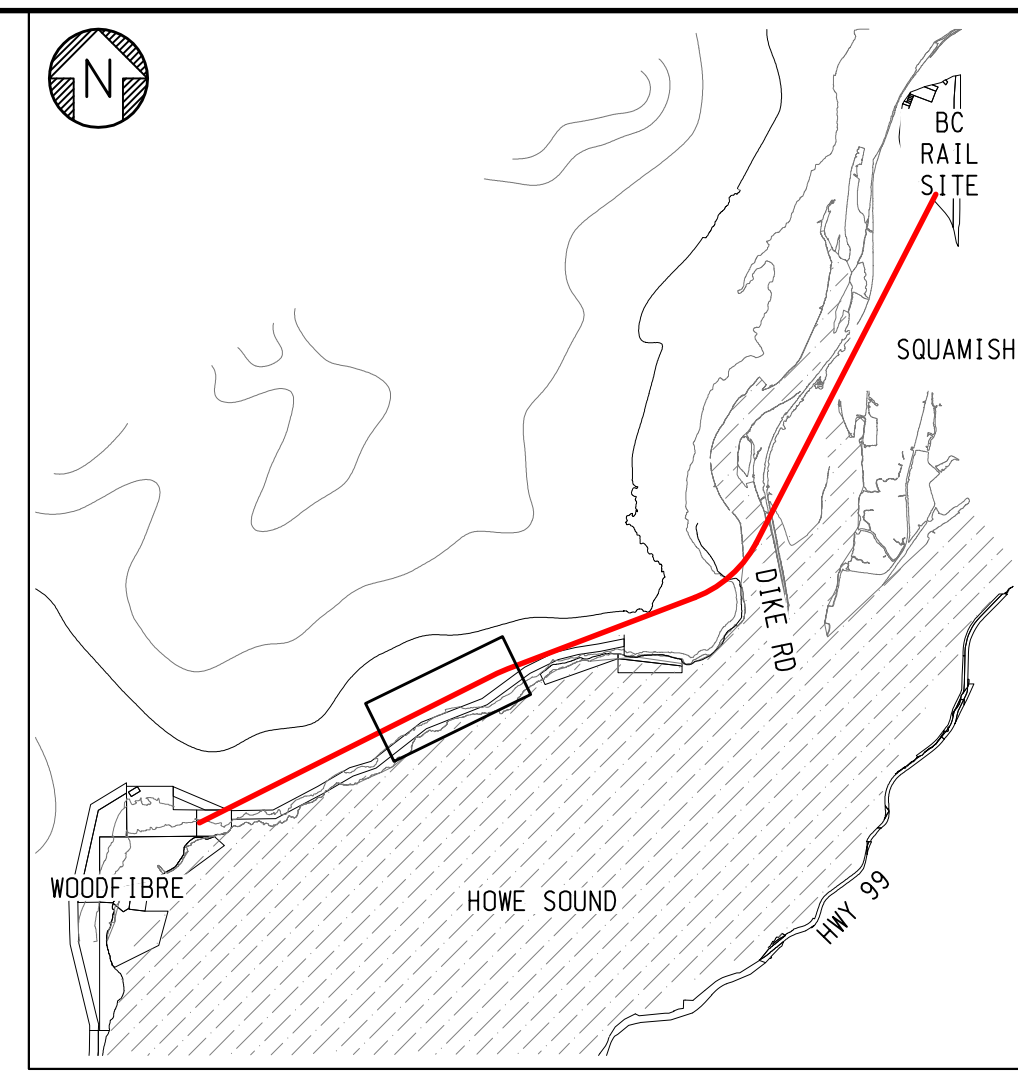
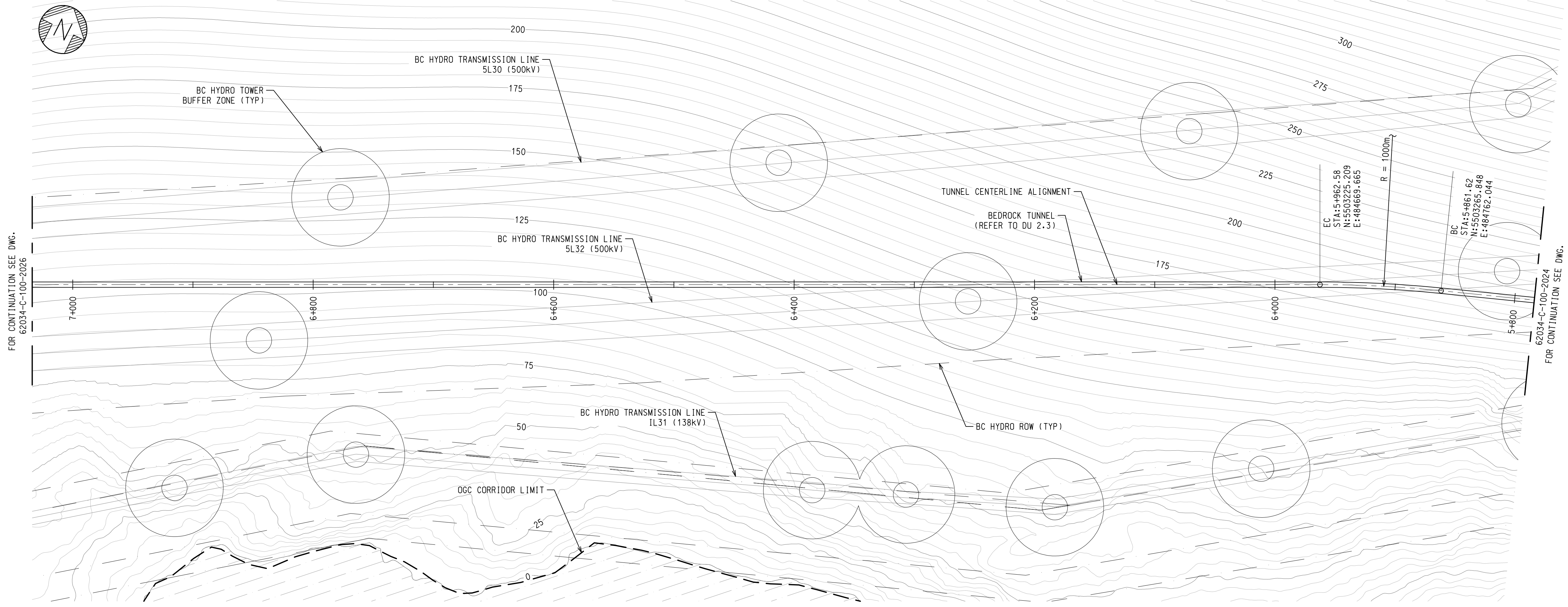

- NOTES:**
1. REFER TO DWG 62034-C-100-2003 FOR MAPPING LEGEND AND NOTES.
 2. REFER TO DWG 62034-C-100-2020 FOR ABBREVIATIONS AND ACRONYMS.

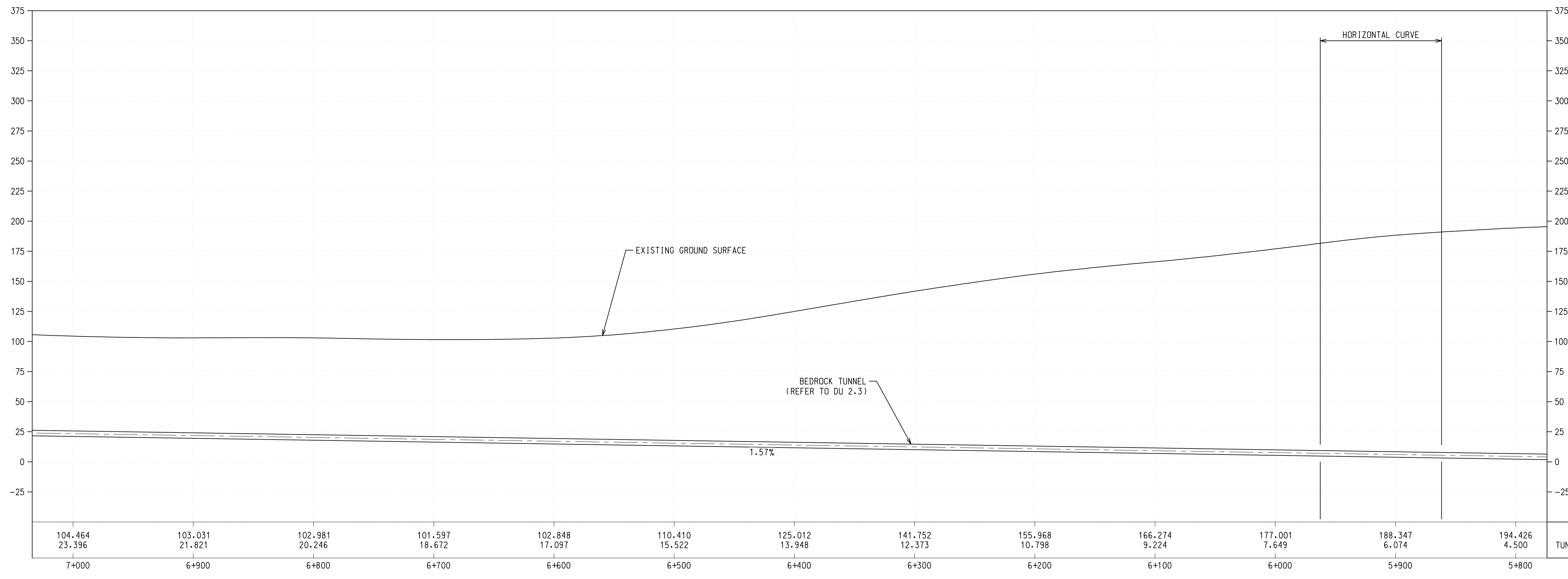

ISSUED FOR CONSTRUCTION
2022-06-24

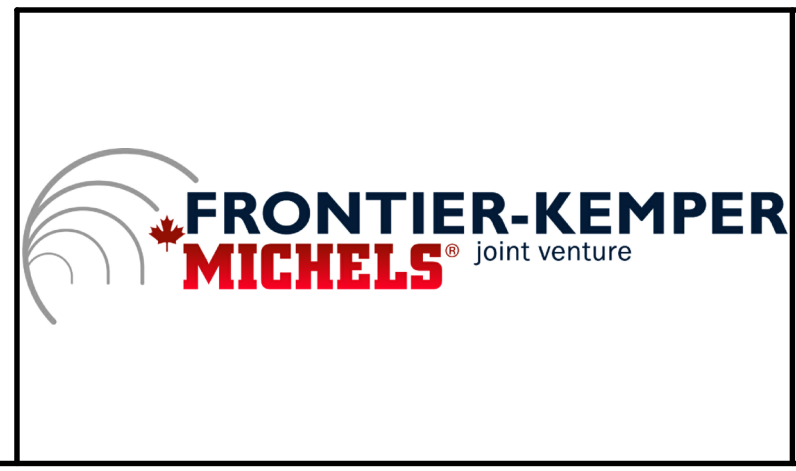
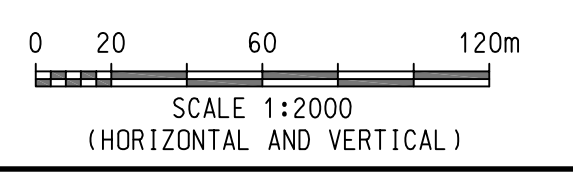

RO						
ALDEA	RO	ISSUED FOR CONSTRUCTION	R. JIANG	G. MONGE	B. YANG	2022-06-24
BY	No.	REVISION	DRAWN	DESIGNED	CHECKED	DATE (YYYY-MM-DD)
			PREVIOUS DR. NO. -		SCALE - AS SHOWN	

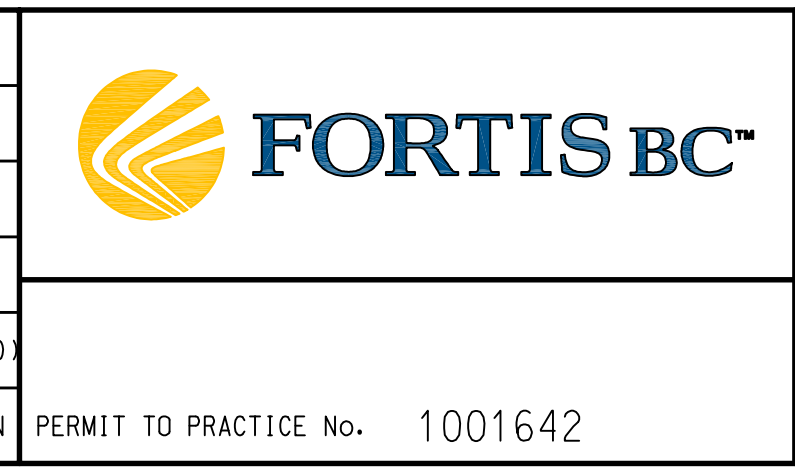

EGP NORTH 610 TP PIPELINE

TUNNEL PLAN AND PROFILE
SHEET 6
STA 5+784 TO STA 7+034

DRAWING NUMBER 62034-C-100-2025-R0

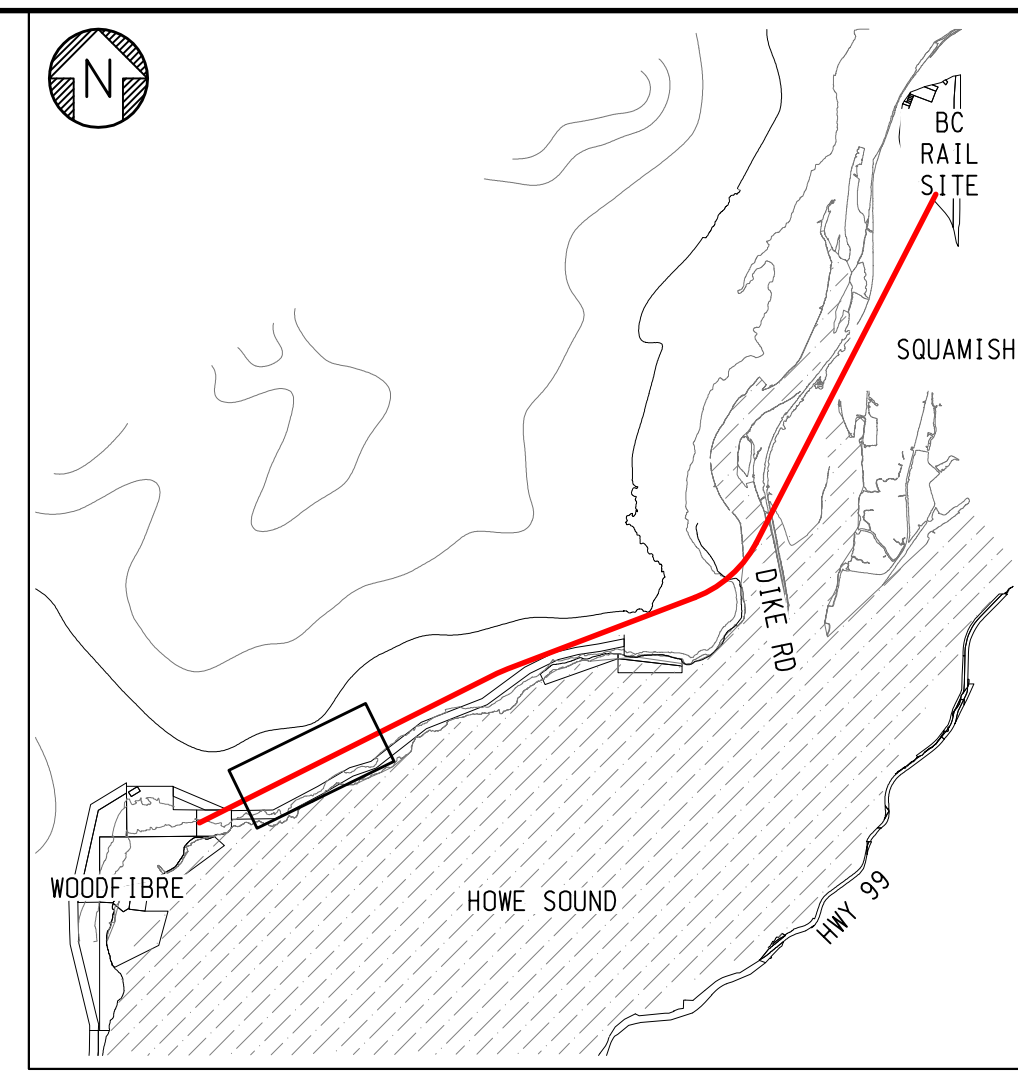
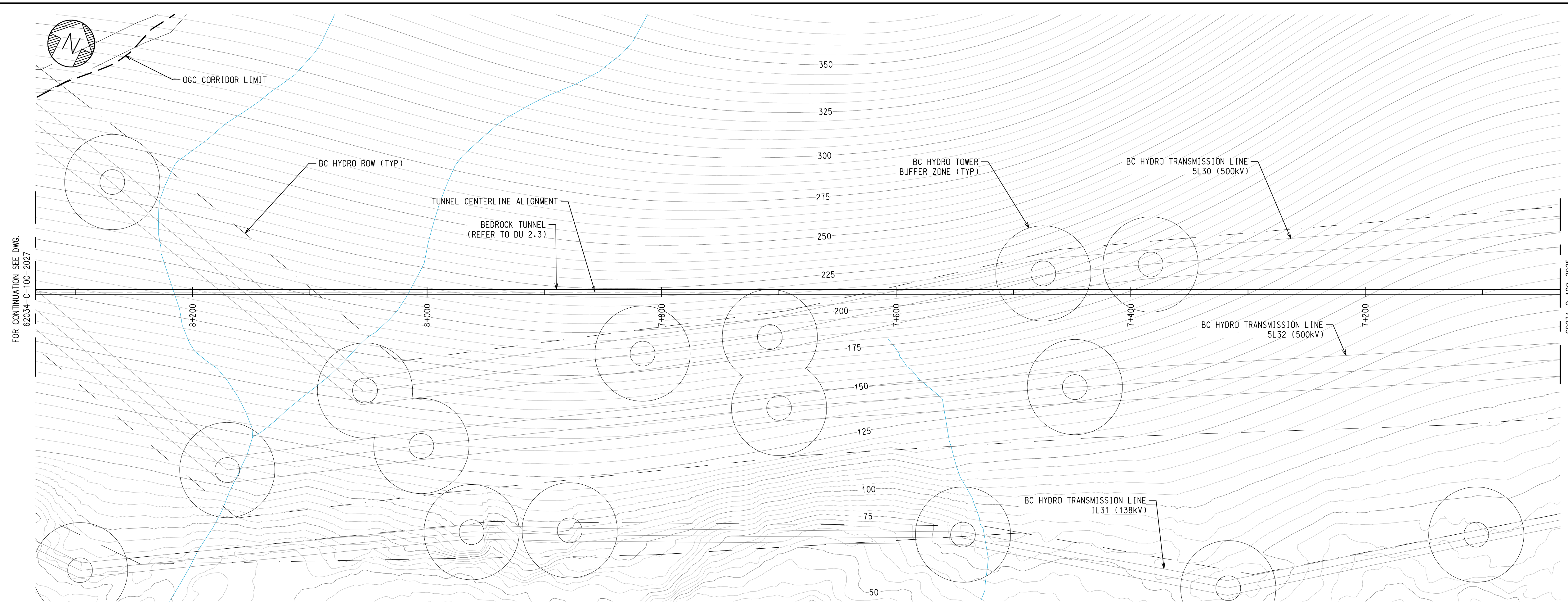

KEY PLAN
NTS

- NOTES:**
- REFER TO DWG 62034-C-100-2003 FOR MAPPING LEGEND AND NOTES.
 - REFER TO DWG 62034-C-100-2020 FOR ABBREVIATIONS AND ACRONYMS.

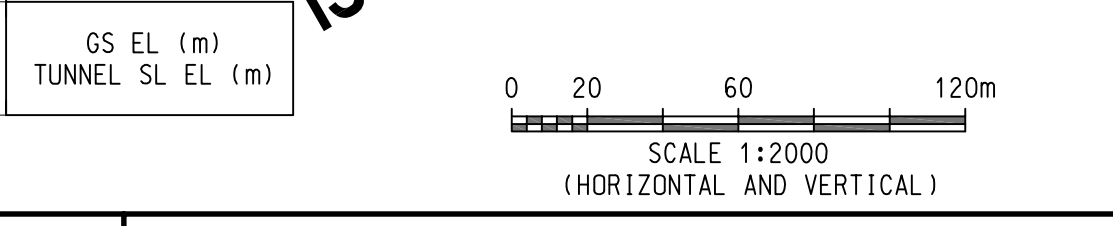
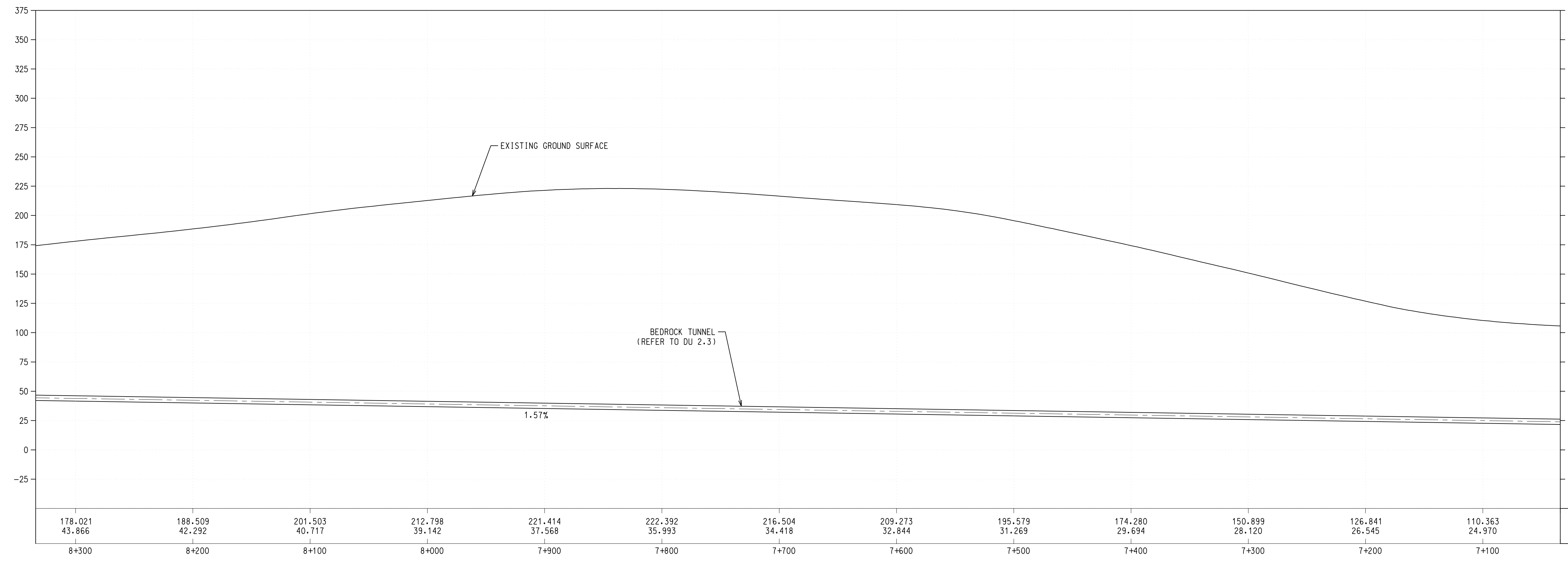

178.021	188.509	201.503	212.798	221.414	222.392	216.504	209.273	195.579	174.280	150.899	126.841	110.363	GS EL (m)
43.866	42.292	40.717	39.142	37.568	35.993	34.418	32.844	31.269	29.694	28.120	26.545	24.970	TUNNEL SL EL (m)
8+300	8+200	8+100	8+000	7+900	7+800	7+700	7+600	7+500	7+400	7+300	7+200	7+100	

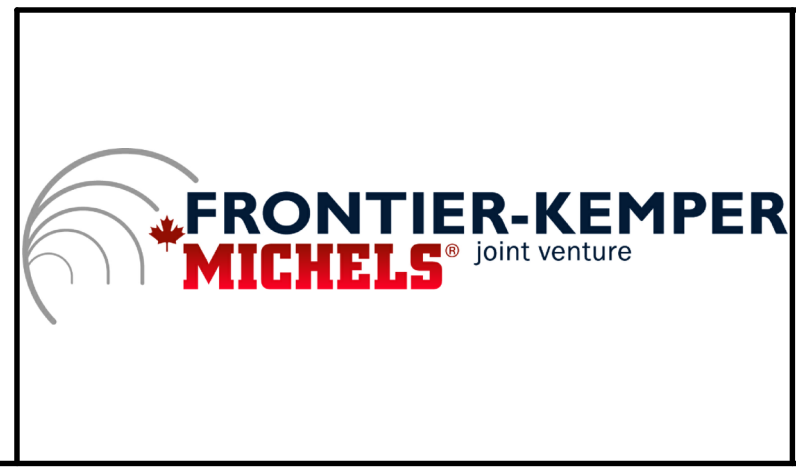

	RO						
ALDEA	RO	ISSUED FOR CONSTRUCTION	R. JIANG	G. MONGE	B. YANG	2022-06-24	
BY	No.	REVISION	DRAWN	DESIGNED	CHECKED	DATE (YYYY-MM-DD)	
PREVIOUS DR. NO. -						SCALE - AS SHOWN	PERMIT TO PRACTICE No. 1001642

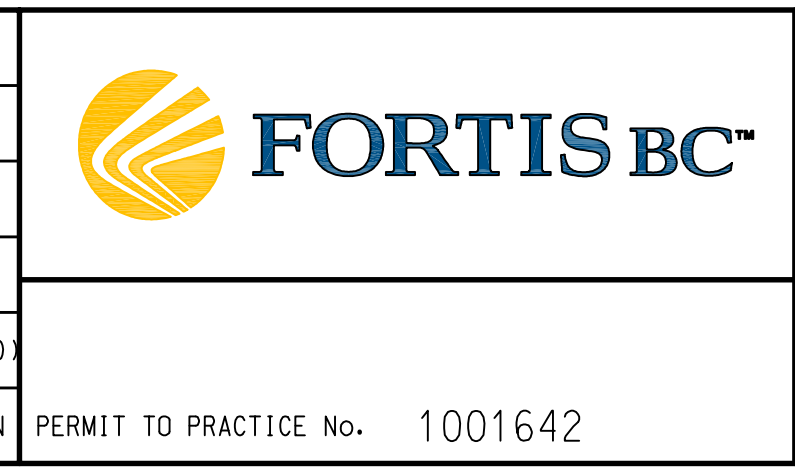

EGP NORTH 610 TP PIPELINE

TUNNEL PLAN AND PROFILE
SHEET 7
STA 7+034 TO STA 8+334

DRAWING NUMBER 62034-C-100-2026-R0

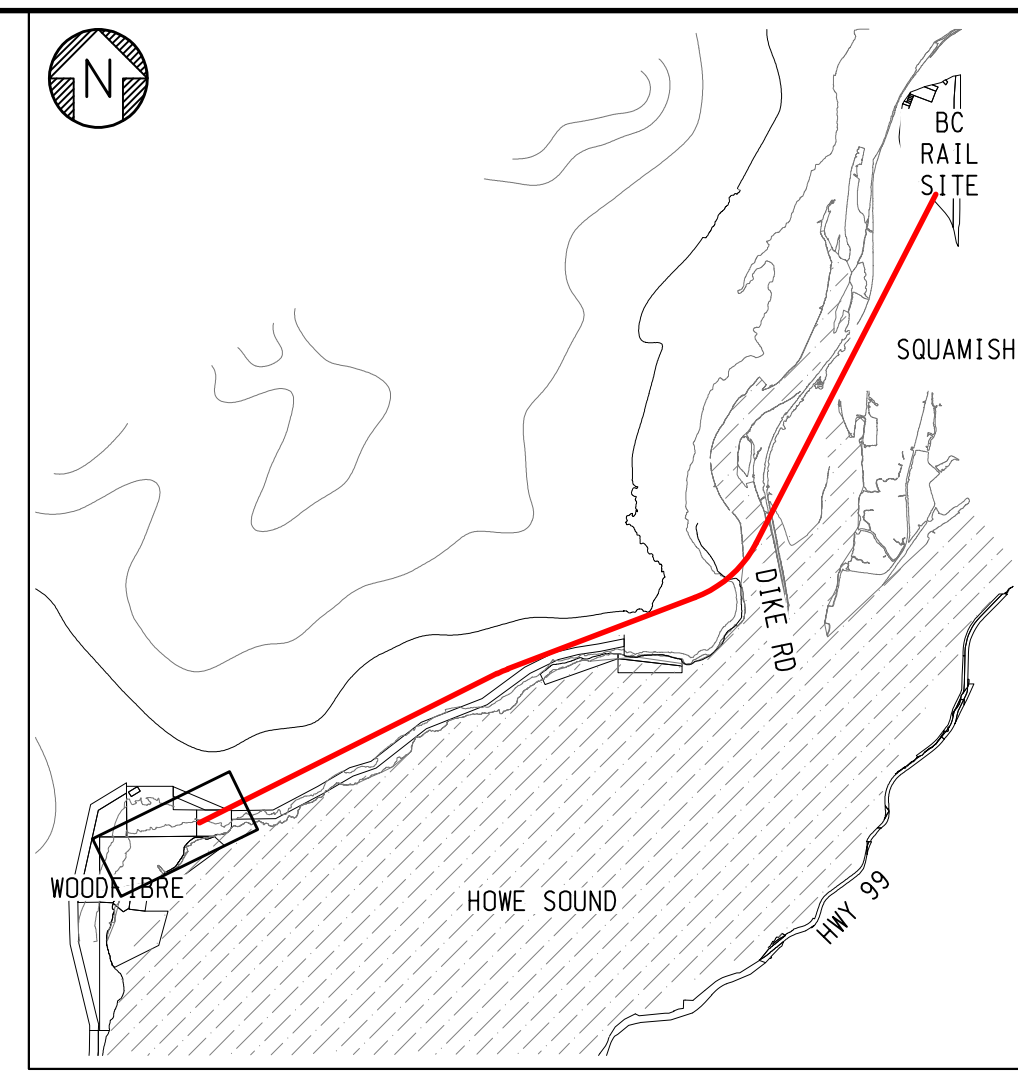
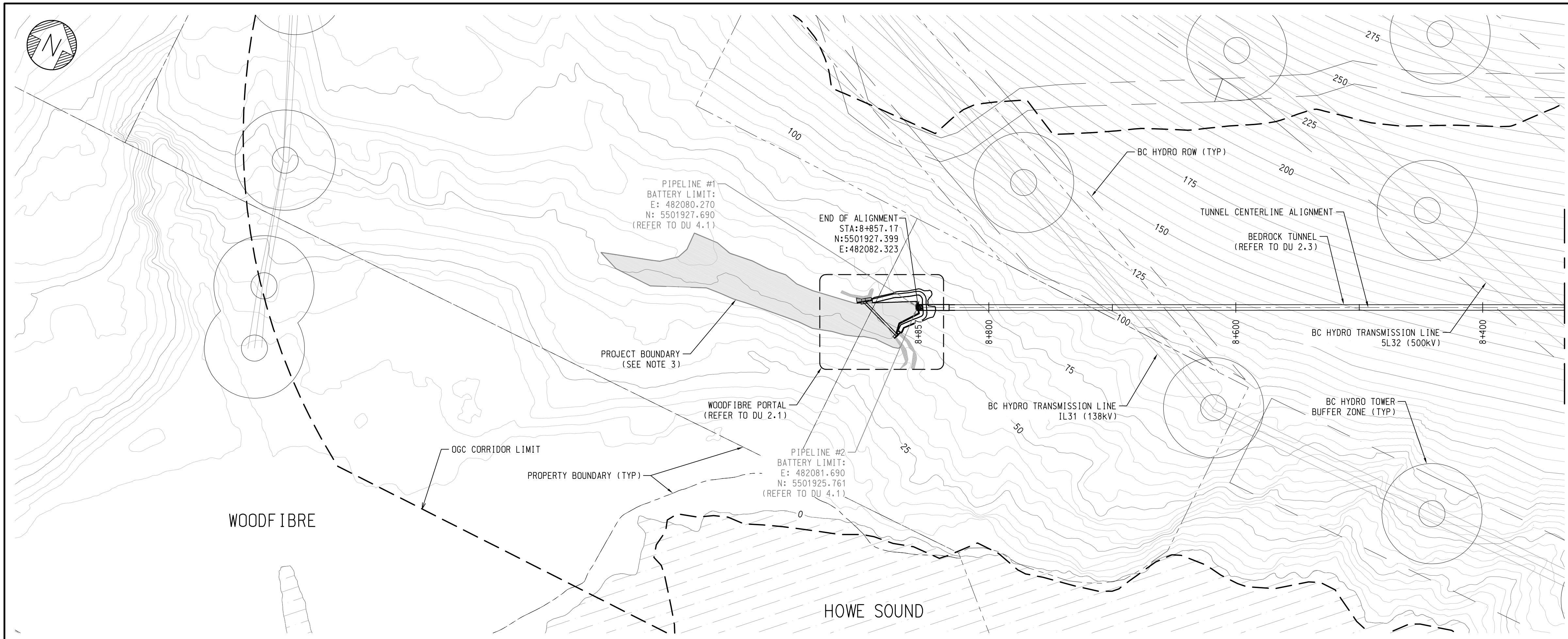

- NOTES:**
- REFER TO DWG 62034-C-100-2003 FOR MAPPING LEGEND AND NOTES.
 - REFER TO DWG 62034-C-100-2020 FOR ABBREVIATIONS AND ACRONYMS.
 - REFER TO DU 3.1 FOR WOODFIBRE SITE FEATURES AND PROJECT BOUNDARIES.

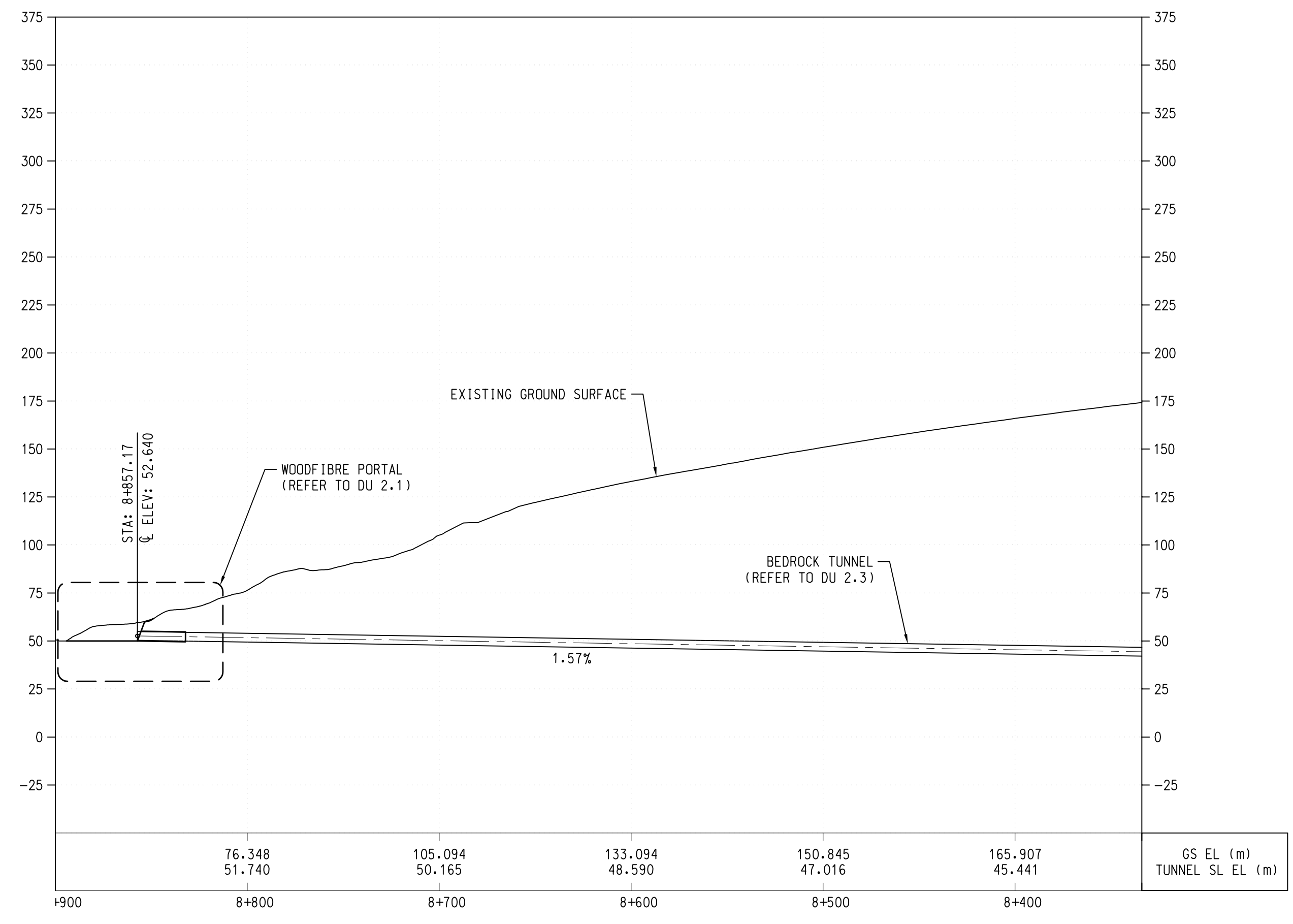

ISSUED FOR CONSTRUCTION
2022-06-24

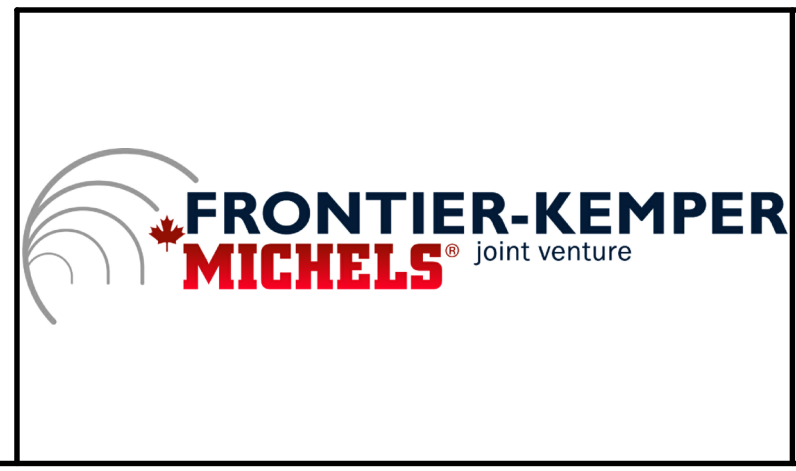
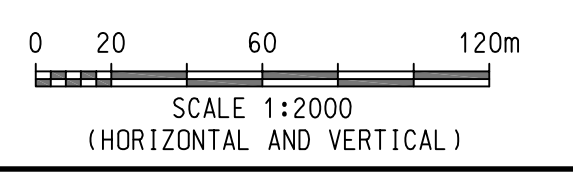

RO						
ALDEA	RO	ISSUED FOR CONSTRUCTION	R. JIANG	G. MONGE	B. YANG	2022-06-24
BY	No.	REVISION	DRAWN	DESIGNED	CHECKED	DATE (YYYY-MM-DD)
			PREVIOUS DR. NO. -		SCALE - AS SHOWN	

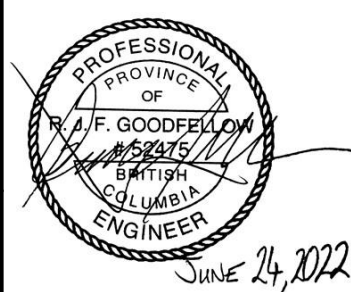

EGP NORTH 610 TP PIPELINE

TUNNEL PLAN AND PROFILE
SHEET 8
STA 8+334 TO STA 8+857.17

DRAWING NUMBER 62034-C-100-2027-RO

PERMIT TO PRACTICE No. 1001642

ENGINEER SEAL